

+NOTICE!!

These documents have been scanned!

Do not place un-scanned documents beneath this notice!

Do not remove this notice from this file!

GPO Jacket No. 560-102
Print Order 61540
Rise Business Services, LLC
Job=AZ15 7/29/2019



Box Number= AZ15179



Claim Begin-End: AMC330887-AMc330888

1 Initial Receipt



AZ15179-4

AMC330680-AMC330967

UNITED STATES
DEPARTMENT OF THE INTERIOR
BUREAU OF LAND MANAGEMENT

RECEIPT AND ACCOUNTING ADVICE

NO. 2061747 04

WG/AZ 05/23/94

Subject: LOCATION FEE & SERVICE FEE (2) 1 2 11 50.00
CLAIM MAINTENANCE FEE 1994 (2) 1 2 12 20.00
Applicant: 1 2 13 200.00

WILLIAM BAKER, ET AL
HC 01 BOX 56
SALOME AZ. 85348

SAME CASH

Remitter:

ENTERED IN COMPUTER

5-26-94 Skinas

Assignor:

LEASE MANAGEMENT DATA										<input type="checkbox"/> NEW	<input type="checkbox"/> UPDATE	<input type="checkbox"/> PAYMENT
ORIGINAL SERIAL NO.		ASG.	TYPE	ST.	CTY.	FUND SYMBOL			ACRES/UNITS	RATE		
AMC 330887-330888												
AMOUNT	ANV. DATE	EXP. DATE	BILL CYC.	S/C	DISTRICT	NEXT BILL	MISC. DATA	U of M	ACTUAL UNITS			
ASSIGNMENT SERIAL NO.		ASG.	TYPE	ST.	CTY.	FUND SYMBOL			ACRES/UNITS	RATE		
AMOUNT	ANV. DATE	EXP. DATE	BILL CYC.	S/C	DISTRICT	NEXT BILL	MISC. DATA	U of M	ACTUAL UNITS			
APPLY REMITTANCE										Remarks:		
ACTION	FUND SYMBOL	CTY.	AMOUNT									
FILING FEE												
RENTAL												
UNEARNED												
REFUND												
TOTAL												
AMOUNT DUE												
<input type="checkbox"/> Lease in Escrow? <input type="checkbox"/> KGS? <input type="checkbox"/> Auto Escalates? <input type="checkbox"/> Auto Renew?										FOR MMS USE ONLY		
Of Interest? Operating Rights? Operator Bond Filed?										BILLEE NUMBER OCS SECTION CODE	FOREST REFUGE	

NOTICE!!

These documents have been scanned!

Do not place un-scanned documents beneath this notice!

Do not remove this notice from this file!

GPO Jacket No. 560-102
Print Order 61540
Rise Business Services, LLC
Job=AZ15 7/29/2019



Box Number= AZ15179



Claim Begin-End: AMC330887-AMc330888

2 Correspondence



AZ15179-4

AMC330680-AMC330967

OFFICIAL COPIES /CF/ /SD READ/ /GROUP/ /SECTION/ /AUTHOR/

3800(952.3)DDM

A MC 328480

A MC 330887

A MC 334690

DEC 20 1996

Mr. Marvin L. Hughes
17524 Lilac Street
Hesperia, California 92345

Dear Mr. Hughes:

According to the official records, the 1997 maintenance fee payment for the following claims was paid by Au True Blue L.L.C., on August 19, 1996:

<u>BLM SERIAL NUMBER</u>	<u>CLAIM NAME</u>
AMC 328480	True Blue # 1
AMC 330887	True Blue
AMC 330888	True Blue # 3

The maintenace fee for the following claims was paid by Larry Elhard, on July 25, 1996.

<u>BLM SERIAL NUMBER</u>	<u>CLAIM NAME</u>
AMC 334690	Gold Carbon # 1
AMC 334691	Gold Carbon # 2
AMC 334692	Gold Carbon # 3
AMC 334693	Gold Carbon # 4
AMC 334694	Gold Carbon # 5
AMC 334695	Gold Carbon # 6
AMC 334696	Gold Carbon # 7
AMC 334697	Gold Carbon # 8
AMC 334698	Gold Carbon # 9

The official records do not show you as an owner of the above claims. A refund in the amount of \$1200.00, paid on August 6, 1996, Receipt and Accounting Advice No. 2263407 will be authorized. Please allow approximately four to six weeks for the refund.

If additional information is required, please contact Dorie Morrison at (602) 417-9518.

Sincerely,

A handwritten signature in cursive script that reads "Mary Jo Yoas".

Mary Jo Yoas
Chief, Lands and Minerals Adjudication

DMORRISON:ers:12/19/96:328480

NOTICE!!

These documents have been scanned!

Do not place un-scanned documents beneath this notice!

Do not remove this notice from this file!

GPO Jacket No. 560-102
Print Order 61540
Rise Business Services, LLC
Job=AZ15 7/29/2019



Box Number= AZ15179



Claim Begin-End: AMC330887-AMc330888

3 Transfers



AZ15179-4

AMC330680-AMC330967

When recorded, return to:

Brett L. Foster
FOSTER & FOSTER L.C.
602 East 300 South
Salt Lake City, Utah 84102



330887
97- 02427

*OFFICIAL RECORDS OF LA PAZ COUNTY, AZ
*PATRICIA WALL, LA PAZ COUNTY RECORDER
REC REQ BY: FOSTER & FOSTER-SASE
25 APR 1997 01:36 PM PAGE 1 of 1
RECORDING FEE \$ 9.00

QUITCLAIM DEED

KNOW ALL MEN BY THESE PRESENTS:

P.A.B. ENTERPRISES, INC. AND R. PAIGE PFEIFER, the undersigned GRANTORS, of Dallas, Texas, Dallas County, for the consideration GRANTORS receive through a "SETTLEMENT AGREEMENT and MUTUAL RELEASE," receipt and sufficiency of which GRANTORS acknowledge, do hereby release, remise, transfer, and forever quitclaim unto AU TRUE BLUE, L.L.C. all right, title, and interest GRANTORS have in 12 mining claims, known as the True Blue Mining Claims (3) and the Gold Carbon Mining Claims (9), situated in La Paz County, Section 9, Range 14, Township 5 North, State of Arizona, which are legally described by the following BLM Serial Nos.:

AMC 330887	AMC 330888	AMC 328480
AMC 334690	AMC 334691	AMC 334692
AMC 334693	AMC 334694	AMC 334695
AMC 334696	AMC 334697	AMC 334698

WITNESS THE HAND OF SAID GRANTORS this 14 day of April, 1997.

R. PAIGE PFEIFER, INDIVIDUALLY

P.A.B. ENTERPRISES, INC.

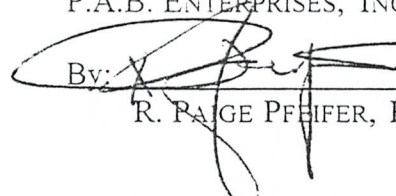
Bv: 
R. PAIGE PFEIFER, PRESIDENT

STATE OF TEXAS)
 SS.
COUNTY OF DALLAS)

ACKNOWLEDGMENT

On this 14 day of April, 1997, R. PAIGE PFEIFER, whom I know, personally appeared before me and executed the foregoing QUITCLAIM DEED, and acknowledged that he did so in his individual capacity and as president of P.A.B. ENTERPRISES, INC. as his own free act and deed.

My commission expires: 5-28-2000

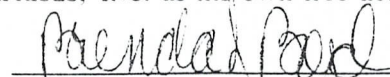
NOTARY PUBLIC

ARIZONA
STATE OFFICE
PHOENIX, ARIZONA

71021 Inwood Rd
Dallas TX
75209

[SEAL]

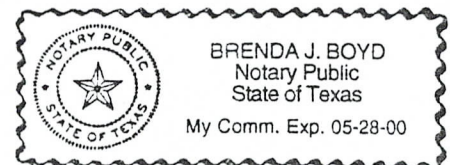

RECEIVED
BUREAU OF
LAND MANAGEMENT
JUN 4 9 47 AM '97

Not processed; claims reflecting other owners

*OFFICIAL RECORDS OF LA PAZ COUNTY, AZ
*PATRICIA WALL, LA PAZ COUNTY RECORDER
REC REQ BY: FOSTER & FOSTER-SASE
25 APR 1997 01:36 PM PAGE 1 OF 1
RECORDING FEE \$ 9.00

Brett L. Foster
FOSTER & FOSTER L.C.
602 East 300 South
Salt Lake City, Utah 84102

KNOW ALL MEN BY THESE PRESENTS:

SMITH CONSULTING, INC. AND CHARLES W. SMITH, the undersigned GRANTORS, of Chandler, Arizona, Maricopa County for the consideration GRANTORS receive through a "SETTLEMENT AGREEMENT and MUTUAL RELEASE," receipt and sufficiency of which GRANTORS acknowledge, do hereby release, remise, transfer, and forever quitclaim unto AU TRUE BLUE, L.L.C. all right, title, and interest GRANTORS have in 12 mining claims, known as the True Blue Mining Claims (3) and the Gold Carbon Mining Claims (9), situated in La Paz County, Section 9, Range 14, Township 5 North, State of Arizona, which are legally described by the following BLM Serial Nos.:

AMC 330887	AMC 330888	AMC 328480
AMC 334690	AMC 334691	AMC 334692
AMC 334693	AMC 334694	AMC 334695
AMC 334696	AMC 334697	AMC 334698

WITNESS THE HAND OF SAID GRANTORS this 14 day of APRIL, 1997.

X *Charles W. Smith*
CHARLES W. SMITH, INDIVIDUALLY

SMITH CONSULTING, INC.

By: X Charles W. Smith
CHARLES W. SMITH, PRESIDENT

[illegible]

ACKNOWLEDGMENT

On this 14th day of April, 1997, CHARLES W. SMITH, whom I know, personally appeared before me and executed the foregoing QUITCLAIM DEED, and acknowledged that he did so both in his individual capacity and as president of SMITH CONSULTING, INC. as his own free act and deed.

My commission expires: June 14, 1999

Teresa A. Jared
NOTARY PUBLIC

Address: 725 N. Xenomae
W Lh 6 h 101 Chandler, Az
85224

[SEAL]



RECEIVED
BUREAU OF
LAND MANAGEMENT

not processed

LAW OFFICES
FOSTER & FOSTER L.C.
A LIMITED LIABILITY COMPANY

LYNN G. FOSTER
BRETT L. FOSTER†
L. GRANT FOSTER‡
ROBERT D. WASSON

602 EAST 300 SOUTH
SALT LAKE CITY, UTAH 84102

TELEPHONE: (801) 364-5633
FACSIMILE: (801) 355-8938
INTERNET: foster@utah-inter.net

PATENTS
TRADEMARKS
COPYRIGHTS
TRADE SECRETS
UNFAIR COMPETITION
LICENSING
CONTRACTS
RELATED LITIGATION

† Also Member Arizona Bar
‡ Also Member Washington Bar

29 May 1997

Bureau of Land Management
Arizona State Office
222 North Central Avenue
Phoenix, Arizona 85004-2203

Re: AU True Blue, L.L.C.
Quit Claim Deeds

RECEIVED
BUREAU OF
LAND MANAGEMENT
JUN 4 9 47 AM '97
ARIZONA
STATE OFFICE
PHOENIX, ARIZONA

To Whom It May Concern:

On 13 May 1997, I spoke with Tony Smith in the Public Room of your office regarding the enclosed Quit Claim Deeds. He indicated that in order to have the Quit Claim Deeds recorded with your office we needed to include the following: (1) a copy of the Quit Claim deeds; and (2) a check for \$120.00 (\$5.00 for each serial number on each deed). Mr. Smith also indicated that by sending an additional copy and a self addressed stamped envelope, we would receive back from your office a date stamped copy of the Quit Claim Deeds. Therefore, I am enclosing copies of the quit claim deeds, a check and self addressed stamped envelope.

Mr. Smith also informed me that you needed the address of the grantee. The grantee of the Quit Claim Deeds is AU True Blue, L.L.C., Keith L. Hughes, 1950 Vineyard Drive East, Pahrump, Nevada 89048.

I appreciate your assistance in this matter and if you have any questions, please feel free to contact me.

Best regards,

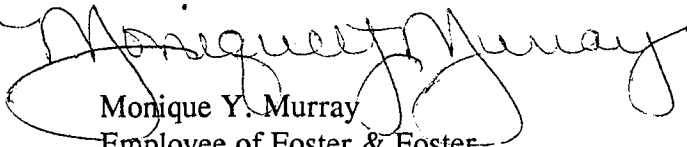
Monique Y. Murray
Employee of Foster & Foster

Enclosures

UNITED STATES
DEPARTMENT OF THE INTERIOR
BUREAU OF LAND MANAGEMENT

RECEIPT AND ACCOUNTING ADVICE

NO. 2314834

TC/AZ

06/05/97

Subject: TRANSFER OF INTEREST - 24

2 3 12

120.00

Applicant:

FOSTER & FOSTER LC
602 EAST 300 SOUTH
SALT LAKE CITY UT 84102

Remitter: CK 2551

Assignor:

LEASE MANAGEMENT DATA ☐ NEW ☐ UPDATE ☐ PAYMENT

ORIGINAL SERIAL NO.	ASG.	TYPE	ST.	CTY.	FUND SYMBOL	ACRES/UNITS	RATE
NMC 300887, ET AL							

AMOUNT	ANV. DATE	EXP. DATE	BILL CYC.	S/C	DISTRICT	NEXT BILL	MISC. DATA	U of M	ACTUAL UNITS

ASSIGNMENT SERIAL NO.	ASG.	TYPE	ST.	CTY.	FUND SYMBOL	ACRES/UNITS	RATE

AMOUNT	ANV. DATE	EXP. DATE	BILL CYC.	S/C	DISTRICT	NEXT BILL	MISC. DATA	U of M	ACTUAL UNITS

APPLY REMITTANCE

ACTION	FUND SYMBOL	CTY.	AMOUNT
FILING FEE			
RENTAL			
UNEARNED			
REFUND			120.00
TOTAL			
AMOUNT DUE			

Remarks:

*Needs not processed.
Refund authorized.*

BY:

Mary B. Hyde

DATE:

6/10/97☐ Lease in Escrow?☐ KGS?☐ Auto Escalates?☐ Auto Renew?

Of Interest?

Operating Rights?

Operator

Bond Filed?

FOR MMS USE ONLY

BILLEE

NUMBER

OCS SECTION

CODE

FOREST REFUGE

When recorded, mail to:

Name: THE TRUE BLUE, L.L.C.
Address: 5800 W SARAGOSA ST

City/State/Zip Code: CHANDLER, AZ. 85226

328480

330887

Space above this line for Recorder's use

QUITCLAIM DEED TO JOINT TENANCY

KNOW ALL MEN BY THESE PRESENTS:

That I(we), CARL A. Russell AND WILLIAM BAKER, the undersigned grantor(s), for the consideration of Ten Dollars (\$10.00) and other valuable considerations, do hereby release, remise and forever quitclaim unto THE TRUE BLUE, L.L.C.

the Releasee(s), as joint tenants with rights of survivorship, all rights, title and interest in that certain ~~Real~~ Property situated in La Paz County, State of AZ and legally described as follows:

R 14, T 5N, SEC 9, AMC #5
330887
330888
328480

PHOENIX, ARIZONA

OCT 18 12 46 PM '95

RECEIVED
B.L.M. AZ STATE OFFICE

IN WITNESS WHEREOF, I(we) have hereunto set my(our) hand(s) and seal this 18th day of October, 19 95.

Witness (if required under State Laws)

Witness (if required under State Laws)

Carl A. Russell
Releasor
William H. Baker
Releasor

State of ARIZONA)
County of MARICOPA) ss.

ACKNOWLEDGMENT

On this 18th day of OCTOBER, 19 95, before me, the undersigned Notary Public, personally appeared CARL A. RUSSELL AND WILLIAM H. BAKER.

known to me to be the individual(s) who executed the foregoing instrument and acknowledged the same to be his(her)(their) free act and deed.

My Commission Expires: 4/11/97



ENTERED IN COMPUTER

1/9/96

Form 1370-41
(March 1984)

UNITED STATES
DEPARTMENT OF THE INTERIOR
BUREAU OF LAND MANAGEMENT

RECEIPT AND ACCOUNTING ADVICE

NO. **2189885**

TC/AZ

10/18/95

Subject: TRANSFER OF INTEREST (3)

1 3 12

15.00

Applicant:

AU TRUE BLUE, L.L.C.
5800 W. SARAGOSA ST
CHANDLER, AZ 85226

SAME AS CASH

Remitter:

Assignor:

LEASE MANAGEMENT DATA ☐ NEW ☐ UPDATE ☐ PAYMENT

ORIGINAL SERIAL NO.	ASG.	TYPE	ST.	CTY.	FUND SYMBOL	ACRES/UNITS	RATE
AMC 330587, ET AL							

AMOUNT	ANV. DATE	EXP. DATE	BILL CYC.	S/C	DISTRICT	NEXT BILL	MISC. DATA	U of M	ACTUAL UNITS

ASSIGNMENT SERIAL NO.	ASG.	TYPE	ST.	CTY.	FUND SYMBOL	ACRES/UNITS	RATE

AMOUNT	ANV. DATE	EXP. DATE	BILL CYC.	S/C	DISTRICT	NEXT BILL	MISC. DATA	U of M	ACTUAL UNITS

APPLY REMITTANCE			
ACTION	FUND SYMBOL	CTY.	AMOUNT
FILING FEE			
RENTAL			
UNEARNED			
REFUND			
TOTAL			
AMOUNT DUE			

Remarks:

BY:

DATE:

<input type="checkbox"/> Lease in Escrow?	Of Interest?
<input type="checkbox"/> KGS?	Operating Rights?
<input type="checkbox"/> Auto Escalates?	Operator
<input type="checkbox"/> Auto Renew?	Bond Filed?

FOR MMS USE ONLY

BILLEE	FOREST REFUGE
NUMBER	
OCS SECTION	
CODE	

CASE FOLDER COPY

NOTICE!!

These documents have been scanned!

Do not place un-scanned documents beneath this notice!

Do not remove this notice from this file!

GPO Jacket No. 560-102
Print Order 61540
Rise Business Services, LLC
Job=AZ15 7/29/2019



Box Number= AZ15179



Claim Begin-End: AMC330887-AMc330888

4 Annual Filings



AZ15179-4

AMC330680-AMC330967

UNITED STATES
DEPARTMENT OF THE INTERIOR
BUREAU OF LAND MANAGEMENT

330887
328480

CREDIT CARD PAYMENT
For Mining Claim Maintenance Fee

☐ THIS IS A CHANGE OF ADDRESS

TELEPHONE SUBMISSION - ACCURACY OF THE BELOW INFORMATION IS THE RESPONSIBILITY OF THE CLAIMANT/OWNER

NAME KEITH HUGHES
ADDRESS P.O. Box 3697
CITY PRESCOTT STATE AZ ZIP 86302
PHONE # 928 - 710-3545

SEND RECEIPT TO ☒ Above address
☐ Other (include Name and Mailing Address):

AMC NUMBER

330887
330888
328480

CLAIM/SITE NAME

TRUE BLUE 1
TRUE BLUE 2
TRUE BLUE 3

3 # of Claim/Site

x 155.00 Each

\$ 465.00 Total Charged EG (INITIALS)

RECEIPT # 4249213

DATE STAMP

ENTERED
AUG 30 2018
BY: Ram

RECEIVED
BLM AZ STATE OFFICE
2018 AUG 29 P 3:41
PHOENIX, ARIZONA

***** FOR OFFICIAL USE ONLY *****

DATE _____ INITIALS _____ VERIFIED _____

United States Department of the Interior
Bureau of Land Management
DIV OF LANDS, MINRLS & ENERGY
ONE N CENTRAL AVE
PHOENIX, AZ 85004 -4427
Phone: 602-417-9200

Receipt

No: 4249213

Transaction #: 4364699	
Date of Transaction: 08/29/2018	
CUSTOMER:	
	KEITH HUGHES PO BOX 3697 PRESCOTT, AZ 86302-3697 US

LINE #	QTY	DESCRIPTION	REMARKS	UNIT PRICE	TOTAL
1	1.00	LOCATABLE MINERALS / MINING CLAIMS- NOT NEW-UNADJUD, ONE AUTH NO. ONLY / MINING CLAIM MONEY RECEIVED CASES: AMC330887/\$465.00	2019 MAINT (3)	- n/a -	465.00
TOTAL:					\$465.00

PAYMENT INFORMATION				
NOTE: Items will appear on credit card statement as "Bureau of Land Mgmt CO".				
1	AMOUNT:	465.00	POSTMARKED:	N/A
	TYPE:	CREDIT CARD	RECEIVED:	08/29/2018
	NAME:	HUGHES, KEITH PO BOX 3697 PRESCOTT AZ 86302-3697 US		
	CARD NO:	XXXXXXXXXXXX3008	AUTH CODE:	162516
	NAME ON CARD:	KEITH HUGHES		
	SIGNATURE:			

REMARKS

This receipt was generated by the automated BLM Collections and Billing System and is a paper representation of a portion of the official electronic record contained therein.

UNITED STATES
DEPARTMENT OF THE INTERIOR
BUREAU OF LAND MANAGEMENT

330887

328480

CREDIT CARD PAYMENT
For Mining Claim Maintenance Fee

☐

TELEPHONE SUBMISSION - ACCURACY OF THE BELOW INFORMATION IS THE RESPONSIBILITY OF THE CLAIMANT/OWNER

NAME KEITH HUGHES
ADDRESS P.O. BOX 3697
CITY PRESCOTT STATE AZ ZIP 86302
PHONE # 928 - 710-3545

SEND RECEIPT TO ☒ Above address
☐ Other (Include Name and Mailing Address):

AMC NUMBER

330887
330888
328480

CLAIM/SITE NAME

TRUE BLUE 1
TRUE BLUE 2
TRUE BLUE 3

3 # of Claim/Site
x 155.00 Each
\$ 465.00 Total Charged AS (INITIALS)

RECEIPT # 3965087

DATE STAMP

ENTERED
AUG 30 2017
BY: Rgn

PHOENIX, ARIZ

2017 AUG 29 P 1:45

RECEIVED
BLM AZ STATE OFFICE

***** FOR OFFICIAL USE ONLY *****

DATE _____

INITIALS _____

VERIFIED _____

United States Department of the Interior
Bureau of Land Management
DIV OF LANDS, MINRLS & ENERGY
ONE N CENTRAL AVE
PHOENIX, AZ 85004 -4427
Phone: 602-417-9200

Receipt

No: 3965087

Transaction #: 4074963	
Date of Transaction: 08/29/2017	
CUSTOMER:	
	KEITH HUGHES PO BOX 3697 PRESCOTT, AZ 86302-3697 US

LINE #	QTY	DESCRIPTION	REMARKS	UNIT PRICE	TOTAL
1	1.00	LOCATABLE MINERALS / MINING CLAIMS- NOT NEW-UNADJUD, ONE AUTH NO. ONLY / MINING CLAIM MONEY RECEIVED CASES: AMC330887/\$465.00	2018 MAINT (3)	- n/a -	465.00
TOTAL:					\$465.00

PAYMENT INFORMATION				
NOTE: Items will appear on credit card statement as "Bureau of Land Mgmt CO".				
1	AMOUNT:	465.00	POSTMARKED:	N/A
	TYPE:	CREDIT CARD	RECEIVED:	08/29/2017
	NAME:	HUGHES, KEITH PO BOX 3697 PRESCOTT AZ 86302-3697 US		
	CARD NO:	XXXXXXXXXXXX1002	AUTH CODE:	143430
	NAME ON CARD:	KEITH HUGHES		
	EXPIRES:	04/2022		
	SIGNATURE:			

REMARKS

This receipt was generated by the automated BLM Collections and Billing System and is a paper representation of a portion of the official electronic record contained therein.

UNITED STATES
DEPARTMENT OF THE INTERIOR
BUREAU OF LAND MANAGEMENT

330887
328480

CREDIT CARD PAYMENT
For Mining Claim Maintenance Fee

☐

TELEPHONE SUBMISSION - ACCURACY OF THE BELOW INFORMATION IS THE RESPONSIBILITY OF THE CLAIMANT/OWNER

NAME KEITH HUGHES
ADDRESS P.O. BOX 3697
CITY PRESCOTT STATE AZ ZIP 86302
PHONE # 928 - 710-3545

SEND RECEIPT TO ☒ Above address
☐ Other (Include Name and Mailing Address):

AMC NUMBER

330887
330888
328480

CLAIM/SITE NAME

TRUE BLUE 1
TRUE BLUE 2
TRUE BLUE 3

3 # of Claim/Site
X 155.00 Each
\$ 465.00 Total Charged KS (INITIALS)

RECEIPT # 3965087

DATE STAMP

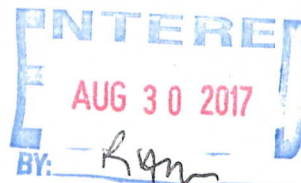

RECEIVED
BLM AZ STATE OFFICE
2017 AUG 29 P 1:11
PHOENIX, ARIZ

***** FOR OFFICIAL USE ONLY *****

DATE _____ INITIALS _____ VERIFIED _____

United States Department of the Interior
Bureau of Land Management
 DIV OF LANDS, MINRLS & ENERGY
 ONE N CENTRAL AVE
 PHOENIX, AZ 85004 -4427
 Phone: 602-417-9200

Receipt

No: 3965087

Transaction #: 4074963	
Date of Transaction: 08/29/2017	
CUSTOMER:	
	KEITH HUGHES PO BOX 3697 PRESCOTT, AZ 86302-3697 US

LINE #	QTY	DESCRIPTION	REMARKS	UNIT PRICE	TOTAL
1	1.00	LOCATABLE MINERALS / MINING CLAIMS- NOT NEW-UNADJUD, ONE AUTH NO. ONLY / MINING CLAIM MONEY RECEIVED CASES: AMC330887/\$465.00	2018 MAINT (3)	- n/a -	465.00
TOTAL:					\$465.00

PAYMENT INFORMATION			
NOTE: Items will appear on credit card statement as "Bureau of Land Mgmt CO".			
1	AMOUNT:	465.00	POSTMARKED: N/A
	TYPE:	CREDIT CARD	RECEIVED: 08/29/2017
	NAME:	HUGHES, KEITH PO BOX 3697 PRESCOTT AZ 86302-3697 US	
	CARD NO:	XXXXXXXXXXXX1002	AUTH CODE: 143430
	NAME ON CARD:	KEITH HUGHES	
	EXPIRES:	04/2022	
	SIGNATURE:		

REMARKS

This receipt was generated by the automated BLM Collections and Billing System and is a paper representation of a portion of the official electronic record contained therein.

UNITED STATES
DEPARTMENT OF THE INTERIOR
BUREAU OF LAND MANAGEMENT

330887

328480

CREDIT CARD PAYMENT
For Mining Claim Maintenance Fee

☐

TELEPHONE SUBMISSION - ACCURACY OF THE BELOW INFORMATION IS THE RESPONSIBILITY OF THE CLAIMANT/OWNER

NAME KEITH HUGHES
ADDRESS P.O. BOX 3697
CITY PRESCOTT STATE AZ ZIP 86302
PHONE # 928 - 710-3545

SEND RECEIPT TO ☒ Above address
☐ Other (Include Name and Mailing Address):

AMC NUMBER

330887
330888
328480

CLAIM/SITE NAME

TRUE BLUE 1
TRUE BLUE 2
TRUE BLUE 3

3 # of Claim/Site
x 155.00 Each
\$ 465.00 Total Charged RS (INITIALS)

RECEIPT # 3965087

DATE STAMP



PHOENIX, ARIZ

2017 AUG 29 P 1:11

RECEIVED
BLM AZ STATE OFFICE

***** FOR OFFICIAL USE ONLY *****

DATE _____ INITIALS _____ VERIFIED _____

United States Department of the Interior

Bureau of Land Management

DIV OF LANDS, MINRLS & ENERGY

ONE N CENTRAL AVE

PHOENIX, AZ 85004 -4427

Phone: 602-417-9200

Receipt

No:

3965087

Transaction #: 4074963	
Date of Transaction: 08/29/2017	
CUSTOMER:	
	KEITH HUGHES PO BOX 3697 PRESCOTT, AZ 86302-3697 US

LINE #	QTY	DESCRIPTION	REMARKS	UNIT PRICE	TOTAL
1	1.00	LOCATABLE MINERALS / MINING CLAIMS- NOT NEW-UNADJUD, ONE AUTH NO. ONLY / MINING CLAIM MONEY RECEIVED CASES: AMC330887/\$465.00	2018 MAINT (3)	- n/a -	465.00
TOTAL:					\$465.00

PAYMENT INFORMATION			
NOTE: Items will appear on credit card statement as "Bureau of Land Mgmt CO".			
1	AMOUNT:	465.00	POSTMARKED: N/A
	TYPE:	CREDIT CARD	RECEIVED: 08/29/2017
	NAME:	HUGHES, KEITH PO BOX 3697 PRESCOTT AZ 86302-3697 US	
	CARD NO:	XXXXXXXXXXXX1002	AUTH CODE: 143430
	NAME ON CARD:	KEITH HUGHES	
	EXPIRES:	04/2022	
	SIGNATURE:		

REMARKS

This receipt was generated by the automated BLM Collections and Billing System and is a paper representation of a portion of the official electronic record contained therein.

UNITED STATES
DEPARTMENT OF THE INTERIOR
BUREAU OF LAND MANAGEMENT

328480

330887

CREDIT CARD PAYMENT
For Mining Claim Maintenance Fee

☐ THIS IS A CHANGE OF ADDRESS

TELEPHONE SUBMISSION - ACCURACY OF THE BELOW INFORMATION IS THE RESPONSIBILITY OF THE CLAIMANT/OWNER

NAME KEITH HUGHES
ADDRESS P.O. Box 3697
CITY PRESCOTT STATE AZ ZIP 86302
PHONE # 928 - 710 3545

SEND RECEIPT TO ☐ Above address
☐ Other (Include Name and Mailing Address):

AMC NUMBER

330887

330888

~~328480~~

328480

CLAIM/SITE NAME

TRUE BLUE 1

TRUE BLUE

TRUE BLUE 3

3 # of Claim/Site

x 155.00 Each

\$ 465 Total Charged EH (INITIALS)

RECEIPT # 3629222

DATE STAMP

ENTERED
AUG 15 2016
BY: RAM

RECEIVED
BLM AZ STATE OFFICE
2016 AUG 12 P 2:06
PHOENIX, ARIZONA

***** FOR OFFICIAL USE ONLY *****

DATE _____ INITIALS _____ VERIFIED _____

United States Department of the Interior
Bureau of Land Management
 DIV OF LANDS, MINRLS & ENERGY
 ONE N CENTRAL AVE
 PHOENIX, AZ 85004 -4427
 Phone: 602-417-9200

Receipt

No: 3629222

Transaction #: 3732999	
Date of Transaction: 08/12/2016	
CUSTOMER:	
	KEITH HUGHES PO BOX 3697 PRESCOTT, AZ 86302-3697 US

LINE #	QTY	DESCRIPTION	REMARKS	UNIT PRICE	TOTAL
1	1.00	LOCATABLE MINERALS / MINING CLAIMS- NOT NEW-UNADJUD, ONE AUTH NO. ONLY / MINING CLAIM MONEY RECEIVED CASES: AMC328480/\$465.00	2017 MAINT (3)	- n/a -	465.00
TOTAL:					\$465.00

PAYMENT INFORMATION			
NOTE: Items will appear on credit card statement as "Bureau of Land Mgmt CO".			
1	AMOUNT:	465.00	POSTMARKED: N/A
	TYPE:	CREDIT CARD	RECEIVED: 08/12/2016
	NAME:	HUGHES, KEITH PO BOX 3697 PRESCOTT AZ 86302-3697 US	
	CARD NO:	XXXXXXXXXXXX1002	AUTH CODE: 185801
	NAME ON CARD:	KEITH HUGHES	
	EXPIRES:	06/2020	
	SIGNATURE:		

REMARKS

This receipt was generated by the automated BLM Collections and Billing System and is a paper representation of a portion of the official electronic record contained therein.

UNITED STATES
DEPARTMENT OF THE INTERIOR
BUREAU OF LAND MANAGEMENT

328480

330887

CREDIT CARD PAYMENT
For Mining Claim Maintenance Fee

☐ THIS IS A CHANGE OF ADDRESS

TELEPHONE SUBMISSION - ACCURACY OF THE BELOW INFORMATION IS THE RESPONSIBILITY OF THE CLAIMANT/OWNER

NAME Keith HUGHES
ADDRESS PO BOX 3697
CITY PRESCOTT STATE AZ ZIP 86302
PHONE # 928 - 710-3545

SEND RECEIPT TO ☒ Above address
☐ Other (Include Name and Mailing Address):

AMC NUMBER

330887
330888
328480

CLAIM/SITE NAME

TRUE BLUE 1
TRUE BLUE 2
TRUE BLUE 3

3 # of Claim/Site

x 155.00 Each

\$ 465 Total Charged ERJ (INITIALS)

RECEIPT #

3377004

DATE STAMP

ENTERED
AUG 27 2015
BY: IR

RECEIVED
LM AZ STATE OFFICE
2015 AUG 26 A 9:13
PHOENIX, ARIZONA

***** FOR OFFICIAL USE ONLY *****

DATE

INITIALS

VERIFIED

United States Department of the Interior
Bureau of Land Management
LANDS/RECREATION & PLANNING
ONE N CENTRAL AVE
PHOENIX, AZ 85004 -2203
Phone: 602-417-9200

Receipt

No: 3377004

Transaction #: 3475246

Date of Transaction: 08/26/2015

CUSTOMER:

KEITH HUGHES
PO BOX 3697
PRESCOTT, AZ 86302-3697 US

LINE #	QTY	DESCRIPTION	REMARKS	UNIT PRICE	TOTAL
1	1.00	LOCATABLE MINERALS / MINING CLAIMS- NOT NEW-UNADJUD, ONE AUTH NO. ONLY / MINING CLAIM MONEY RECEIVED CASES: AMC330887/\$465.00	2016 MAINT (3)	- n/a -	465.00
TOTAL:					\$465.00

PAYMENT INFORMATION

NOTE: Items will appear on credit card statement as "Bureau of Land Mgmt CO".

1	AMOUNT:	465.00	POSTMARKED:	N/A
	TYPE:	CREDIT CARD	RECEIVED:	08/26/2015
	NAME:	HUGHES, KEITH PO BOX 3697 PRESCOTT AZ 86302-3697 US		
	CARD NO:	XXXXXXXXXXXX1002	AUTH CODE:	103380
	NAME ON CARD:	KEITH HUGHES		
	EXPIRES:	06/2020		
	SIGNATURE:			

REMARKS

This receipt was generated by the automated BLM Collections and Billing System and is a paper representation of a portion of the official electronic record contained therein.

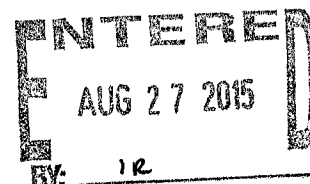

AMC 330887
328480

UNITED STATES
DEPARTMENT OF THE INTERIOR
BUREAU OF LAND MANAGEMENT

CREDIT CARD PAYMENT
FOR MINING CLAIM MAINTENANCE FEE

NAME Keith HUGHES
ADDRESS PO BOX 3697
CITY PRESCOTT STATE AZ ZIP 86302
PHONE # (928) 710-3545

[] THIS IS A CHANGE OF ADDRESS

AMC NUMBER

CLAIM/SITE NAME

330887

True Blue 1

330888

True Blue 2

328480

True Blue 3

DATE STAMP

Rec. 3105937

COUNT

3 \$ 465

INITIALS

EG

TELEPHONE SUBMISSION - ACCURACY OF THE ABOVE INFORMATION
IS THE RESPONSIBILITY OF THE CLAIMANT/OWNER

FOR OFFICIAL USE ONLY

DATE

INITIALS

VERIFIED

RECEIVED
M AZ STATE OFFICE
2014 AUG 19 P 2:44
PHOENIX, ARIZONA

ENTERED
AUG 22 2014
BY Ram

United States Department of the Interior
Bureau of Land Management
 LANDS/RECREATION & PLANNING
 ONE N CENTRAL AVE
 PHOENIX, AZ 85004 -2203
 Phone: 602-417-9200

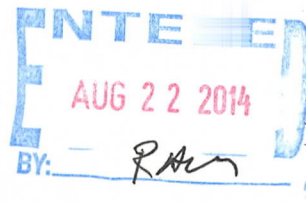

Receipt

No: 3105937

Transaction #: 3197584

Date of Transaction: 08/19/2014

CUSTOMER:

KEITH HUGHES
 PO BOX 3697
 PRESCOTT, AZ 86302-3697 US

LINE #	QTY	DESCRIPTION	REMARKS	UNIT PRICE	TOTAL
1	1.00	LOCATABLE MINERALS / MINING CLAIMS- NOT NEW-UNADJUD, ONE AUTH NO. ONLY / MINING CLAIM MONEY RECEIVED CASES: AMC330887/\$465.00	2015 MAINT (3)	- n/a -	465.00
TOTAL:					\$465.00

PAYMENT INFORMATION

NOTE: Items will appear on credit card statement as "Bureau of Land Mgmt CO".

1	AMOUNT:	465.00	POSTMARKED:	N/A
	TYPE:	CREDIT CARD	RECEIVED:	08/19/2014
	NAME:	HUGHES, KEITH PO BOX 3697 PRESCOTT AZ 86302-3697 US		
	CARD NO:	XXXXXXXXXXXX5017	AUTH CODE:	125605
	NAME ON CARD:	KEITH L HUGHES		
	EXPIRES:	05/2017		
	SIGNATURE:			

REMARKS

This receipt was generated by the automated BLM Collections and Billing System and is a paper representation of a portion of the official electronic record contained therein.

AMC 328480

AMC 330887

MAINTENANCE FEE PAYMENT

Claimant Name: KEITH HUGHES
 Address: PO BOX 3697
 City: PRESCOTT State: AZ Zip: 86302
 Telephone: 928-710-3545
 E-mail address: _____
 Signature: _____

☐ Check here if this is a change of address.

RECEIVED
 BLM ARIZONA OFFICE
 2013 AUG 26 A 9:55
 PHOENIX, ARIZONA
 BLM
 Date
 Stamp

LINE NO.	AMC NUMBER	CLAIM/SITE NAME	ACRES IN CLAIM	TWP	RNG	SEC
1	330887	TRUE BLUE #1	LODE			
2	330888	TRUE BLUE #2	LODE			
3	328480	TRUE BLUE #3	LODE			
4						
5						
6						
7						
8						
9						
10						

List additional claims on Form MCF114.

Bureau of Land Management
 Arizona State Office
www.blm.gov/az/

ENTERED
 SEP 03 2013
 BY: [Signature]

No. of Claims: 3 x \$140 = 420
 Check No: AMEX Init. NCH
 Receipt No.: 2864314
 For BLM Use Only

Form: MCF112
 Revised July 2009

This form is available from the Arizona Department of Mines and Mineral Resources and may be reproduced.

United States Department of the Interior
Bureau of Land Management
LANDS/RECREATION & PLANNING
ONE N CENTRAL AVE
PHOENIX, AZ 85004 -2203
Phone: 602-417-9200

Receipt

No: 2864314

Transaction #: 2950213	
Date of Transaction: 08/26/2013	
CUSTOMER:	
	KEITH HUGHES PO BOX 3697 PRESCOTT, AZ 86302-3697 US

LINE #	QTY	DESCRIPTION	REMARKS	UNIT PRICE	TOTAL
1	1.00	LOCATABLE MINERALS / MINING CLAIMS- NOT NEW-UNADJUD, ONE AUTH NO. ONLY / MINING CLAIM MONEY RECEIVED CASES: AMC330887/\$420.00	MAINT 2014/3	- n/a -	420.00
TOTAL:					\$420.00

PAYMENT INFORMATION				
NOTE: Items will appear on credit card statement as "Bureau of Land Mgmt CO".				
1	AMOUNT:	420.00	POSTMARKED:	N/A
	TYPE:	CREDIT CARD	RECEIVED:	08/26/2013
	NAME:	HUGHES, KEITH PO BOX 3697 PRESCOTT AZ 86302-3697 US		
	CARD NO:	XXXXXXXXXXXX1002	AUTH CODE:	180326
	NAME ON CARD:	KEITH HUGHES		
	EXPIRES:	05/2015		
	SIGNATURE:			

REMARKS

This receipt was generated by the automated BLM Collections and Billing System and is a paper representation of a portion of the official electronic record contained therein.

UNITED STATES
DEPARTMENT OF THE INTERIOR
BUREAU OF LAND MANAGEMENT

Amc 330887
328480

CREDIT CARD PAYMENT
For Mining Claim Maintenance Fee

☐ THIS IS A CHANGE OF ADDRESS

TELEPHONE SUBMISSION - ACCURACY OF THE BELOW INFORMATION IS THE RESPONSIBILITY OF THE CLAIMANT/OWNER

NAME KEITH HUGHES
ADDRESS PO BOX 3697
CITY PRESCOTT STATE AZ ZIP 86302
PHONE # 928 - 710 3545

SEND RECEIPT TO ☒ Above address
☐ Other (Include Name and Mailing Address):

AMC NUMBER

330887

330888

328480

CLAIM/SITE NAME

TRVE BLUE #1

" " #2

#3

420
420 # of Claim/Site

40.00 Each
420 Total Charged 100 (INITIALS)

DATE STAMP

RECEIVED
BLM AZ STATE OFFICE
2012 AUG 27 P 2:14
PHOENIX, ARIZONA

RECEIPT 12641603

9/6/2012 TB
ENTERED INTO COMPUTER

***** FOR OFFICIAL USE ONLY *****

DATE _____ INITIALS _____ VERIFIED _____

United States Department of the Interior
Bureau of Land Management
 LANDS/RECREATION & PLANNING
 ONE N CENTRAL AVE
 PHOENIX, AZ 85004 -2203
 Phone: 602-417-9200

Receipt

No: 2641603

Transaction #: 2722248	
Date of Transaction: 08/27/2012	
CUSTOMER:	
	KEITH HUGHES PO BOX 3697 PRESCOTT, AZ 86302-3697 US

LINE #	QTY	DESCRIPTION	REMARKS	UNIT PRICE	TOTAL
1	1.00	LOCATABLE MINERALS / MINING CLAIMS- NOT NEW-UNADJUD, ONE AUTH NO. ONLY / MINING CLAIM MONEY RECEIVED CASES: AMC328480/\$420.00	MAINT 2013 / 3	- n/a -	420.00
TOTAL:					\$420.00

PAYMENT INFORMATION			
NOTE: Items will appear on credit card statement as "Bureau of Land Mgmt CO".			
1	AMOUNT:	420.00	POSTMARKED: N/A
	TYPE:	CREDIT CARD	RECEIVED: 08/27/2012
	NAME:	HUGHES, KEITH PO BOX 3697 PRESCOTT AZ 86302-3697 US	
	CARD NO:	XXXXXXXXXXXX1002	AUTH CODE: 141933
	NAME ON CARD:	KEITH HUGHES	
	EXPIRES:	05/2015	
	SIGNATURE:		

REMARKS

This receipt was generated by the automated BLM Collections and Billing System and is a paper representation of a portion of the official electronic record contained therein.

UNITED STATES
DEPARTMENT OF THE INTERIOR
BUREAU OF LAND MANAGEMENT

CREDIT CARD PAYMENT
For Mining Claim Maintenance Fee

AmC 330887

AmC 328480

☐ THIS IS A CHANGE OF ADDRESS

TELEPHONE SUBMISSION - ACCURACY OF THE BELOW INFORMATION IS THE RESPONSIBILITY OF THE CLAIMANT/OWNER

NAME KEITH HUGHES
ADDRESS P.O. BOX 3697
CITY PRESCOTT STATE AZ ZIP 86302
PHONE # 928 - 710-3545

SEND RECEIPT TO ☒ Above address
☐ Other (Include Name and Mailing Address):

AMC NUMBER

330887

330888

328480

CLAIM/SITE NAME

TRUE BLUE #1

TRUE BLUE #2

TRUE BLUE #3

3

of Claim/Site

x 140.00 Each

\$ 420

Total Charged fn (INITIALS)

RECEIPT # 2419848

DATE STAMP

SEP 7 2011
Cm

RECEIVED
BLM AZ STATE OFFICE
2011 AUG 29 A 9:37
PHOENIX, ARIZONA

***** FOR OFFICIAL USE ONLY *****

DATE _____

INITIALS _____

VERIFIED _____

United States Department of the Interior
Bureau of Land Management
LANDS/RECREATION & PLANNING
ONE N CENTRAL AVE
PHOENIX, AZ 85004 -2203
Phone: 602-417-9200

Receipt

No: 2419848

Transaction #: 2495261

Date of Transaction: 08/30/2011

CUSTOMER:

KEITH HUGHES
PO BOX 3697
PRESCOTT, AZ 86302-3697 US

LINE #	QTY	DESCRIPTION	REMARKS	UNIT PRICE	TOTAL
1	1.00	LOCATABLE MINERALS / MINING CLAIMS-NOT NEW-UNADJUD, ONE AUTH NO. ONLY / MINING CLAIM MONEY RECEIVED CASES: AMC330887/\$420.00	MAINT (3) 2012	- n/a -	420.00
TOTAL:					\$420.00

PAYMENT INFORMATION

NOTE: Items will appear on credit card statement as "Bureau of Land Mgmt CO".

1	AMOUNT:	420.00	POSTMARKED:	N/A
	TYPE:	CREDIT CARD	RECEIVED:	08/29/2011
	NAME:	HUGHES, KEITH PO BOX 3697 PRESCOTT AZ 86302-3697 US		
	CARD NO:	XXXXXXXXXXXX1002	AUTH CODE:	182912
	NAME ON CARD:	KEITH HUGHES		
	EXPIRES:	05/2014		
	SIGNATURE:			

REMARKS

This receipt was generated by the automated BLM Collections and Billing System and is a paper representation of a portion of the official electronic record contained therein.

UNITED STATES
DEPARTMENT OF THE INTERIOR
BUREAU OF LAND MANAGEMENT

AMC 330887

328480

CREDIT CARD PAYMENT
For Mining Claim Maintenance Fee

☐ THIS IS A CHANGE OF ADDRESS

TELEPHONE SUBMISSION - ACCURACY OF THE BELOW INFORMATION IS THE RESPONSIBILITY OF THE CLAIMANT/OWNER

NAME Keith Hughes
ADDRESS P.O. Box 3697
CITY Prescott STATE AZ ZIP 86302
PHONE # 928 - 710-3545

SEND RECEIPT TO ☒ Above address
☐ Other (Include Name and Mailing Address):

ENTERED INTO COMPUTER

SEP 07 2010

AMC NUMBER

330887
330888
328480

CLAIM/SITE NAME

True Blue
True Blue #3
True Blue #1

3 of Claim/Site

x 140.00 Each

\$ 420.00 Total Charged AH (INITIALS)

RECEIPT # 2198390

DATE STAMP

RECEIVED
BLM AZ STATE OFFICE
2010 AUG 23 P 2:58
PHOENIX, ARIZONA

***** FOR OFFICIAL USE ONLY *****

DATE _____

INITIALS _____

VERIFIED _____

United States Department of the Interior
Bureau of Land Management
 LANDS/RECREATION & PLANNING
 ONE N CENTRAL AVE
 PHOENIX, AZ 85004 -2203
 Phone:

Receipt

No: 2198390

Transaction #: 2268292

Date of Transaction: 08/24/2010

ENTERED INTO COMPUTER

CUSTOMER: KEITH HUGHES
 PO BOX 3697
 PRESCOTT, AZ 86302-3697 US

SEP 07 2010

LINE #	QTY	DESCRIPTION	REMARKS	UNIT PRICE	TOTAL
1	1.00	LOCATABLE MINERALS / MINING CLAIMS- NOT NEW-UNADJUD, ONE AUTH NO. ONLY / MINING CLAIM MONEY RECEIVED CASES: AMC330887/\$420.00	MAINT FEE PYMNT (3) 2011	- n/a -	420.00
TOTAL:					\$420.00

PAYMENT INFORMATION

NOTE: Items will appear on credit card statement as "Bureau of Land Mgmt CO".

1	AMOUNT:	420.00	POSTMARKED:	N/A
	TYPE:	CREDIT CARD	RECEIVED:	08/24/2010
	NAME:	HUGHES, KEITH PO BOX 3697 PRESCOTT AZ 86302-3697 US		
	CARD NO:	XXXXXXXXXXXX1002	AUTH CODE:	184059
	NAME ON CARD:	KEITH HUGHES		
	EXPIRES:	05/2014		
	SIGNATURE:			

REMARKS

This receipt was generated by the automated BLM Collections and Billing System and is a paper representation of a portion of the official electronic record contained therein.

AMC 330887
328480

UNITED STATES
DEPARTMENT OF THE INTERIOR
BUREAU OF LAND MANAGEMENT

CREDIT CARD PAYMENT
For Mining Claim Maintenance Fee

☐ THIS IS A CHANGE OF ADDRESS

TELEPHONE SUBMISSION - ACCURACY OF THE BELOW INFORMATION IS THE RESPONSIBILITY OF THE CLAIMANT/OWNER

NAME Keith Hughes
ADDRESS P.O. Box 3697
CITY Prescott STATE AZ ZIP 86302
PHONE # 928 - 710-3545

SEND RECEIPT TO ☒ Above address
☐ Other (Include Name and Mailing Address):

AMC NUMBER

330887 L
330888
328480 L

CLAIM/SITE NAME

True Blue #1
True Blue #2
True Blue #3

DATE STAMP

3 # of Claim/Site
x 140.00 Each
\$ 420.00 Total Charged AH (INITIALS)

RECEIPT # 1983147

RECEIVED
BLM AZ STATE OFFICE
2009 AUG 17 P 2:42
PHOENIX, ARIZONA

***** FOR OFFICIAL USE ONLY *****

DATE _____ INITIALS _____ VERIFIED _____



United States Department of the Interior
Bureau of Land Management
BUSINESS & SUPPORT SVCS DIV
ONE N CENTRAL AVE SUITE 800
PHOENIX, AZ 85004 -4427
Phone: (602) 417-9200

Receipt

No: 1983147

Transaction #: 2047230

Date of Transaction: 08/20/2009

CUSTOMER: KEITH HUGHES
PO BOX 3697
PRESCOTT, AZ 86302-3697 US

LINE #	QTY	DESCRIPTION	REMARKS	UNIT PRICE	TOTAL
1	1.00	LOCATABLE MINERALS / MINING CLAIMS-NOT NEW-UNADJUD, ONE AUTH NO. ONLY / MINING CLAIM MONEY RECEIVED CASES: AMC330887/\$420.00	MAINT (3)	- n/a -	420.00
TOTAL:					\$420.00

PAYMENT INFORMATION

NOTE: Items will appear on credit card statement as "Bureau of Land Mgmt CO".

1	AMOUNT:	420.00	POSTMARKED:	N/A
	TYPE:	CREDIT CARD	RECEIVED:	08/20/2009
	NAME:	HUGHES, KEITH PO BOX 3697 PRESCOTT AZ 86302-3697 US		
	CARD NO:	XXXXXXXXXXXX8669	AUTH CODE:	020907
	NAME ON CARD:	KEITH HUGHES		
	EXPIRES:	03/2011		
	SIGNATURE:			

REMARKS

This receipt was generated by the automated BLM Collections and Billing System and is a paper representation of a portion of the official electronic record contained therein.

AMC 330887
AMC 328480

UNITED STATES
DEPARTMENT OF THE INTERIOR
BUREAU OF LAND MANAGEMENT

CREDIT CARD PAYMENT
FOR MINING CLAIM MAINTENANCE FEE

NAME Keith HUGHES

ADDRESS PO Box 3697

CITY PRESCOTT STATE AZ ZIP 86302

PHONE # (928) 710-3545

SEND RECEIPT TO ABOVE ADDRESS ☒

SEND RECEIPT TO: _____

AMC NUMBER

CLAIM/SITE NAME

330887

True Blue

330888

True Blue #3

328480

True Blue - #1

DATE STAMP

TELEPHONE SUBMISSION - ACCURACY OF THE ABOVE INFORMATION
IS THE RESPONSIBILITY OF THE CLAIMANT/OWNER

FOR OFFICIAL USE ONLY

DATE

INITIALS

VERIFIED

COUNT 3 \$ 375.00 INITIALS ELC

RECEIVED
B.L.M. AZ STATE OFFICE

2008 AUG 12 P 3:15

PHOENIX, ARIZONA

ENTERED INTO COMPUTER

SEP 02 '08

TSB

United States Department of the Interior
Bureau of Land Management
BUSINESS & SUPPORT SVCS DIV
ONE N CENTRAL AVE SUITE 800
PHOENIX, AZ 85004 -4427
Phone: (602) 417-9200

Receipt

No: 1759648

Transaction #: 1817139

Date of Transaction: 08/12/2008

CUSTOMER: KEITH HUGHES
PO BOX 3697
PRESCOTT, AZ 86302

LINE #	QTY	DESCRIPTION	REMARKS	UNIT PRICE	TOTAL
1	1.00	LOCATABLE MINERALS / MINING CLAIMS-NOT NEW-UNADJUD, ONE AUTH NO. ONLY / MINING CLAIM MONEY RECEIVED (455) CASES: AMC330887/\$375.00	2009 MAINT (3)	- n/a -	375.00
TOTAL:					\$375.00

PAYMENT INFORMATION

NOTE: Items will appear on credit card statement as "Bureau of Land Mgmt CO".

1	AMOUNT:	\$375.00	POSTMARKED:	N/A
	TYPE:	CREDIT CARD	RECEIVED:	08/12/2008
	NAME:	HUGHES, KEITH PO BOX 3697 PRESCOTT AZ 86302		
	CARD NO:	XXXXXXXXXXXX1002	AUTH CODE:	182313
	NAME ON CARD:	KEITH HUGHES		
	EXPIRES:	05/31/2010		
	SIGNATURE:			

REMARKS

AMC 330887
328480

UNITED STATES
DEPARTMENT OF THE INTERIOR
BUREAU OF LAND MANAGEMENT

CREDIT CARD PAYMENT
FOR MINING CLAIM MAINTENANCE FEE

NAME Keith Hughes

ADDRESS BOX 3697

CITY Prescott STATE AZ ZIP 86302

PHONE # (928) 710-3545

SEND RECEIPT TO ABOVE ADDRESS ☒

SEND RECEIPT TO: _____

AMC NUMBER

330887

330888

328480

CLAIM/SITE NAME

True Blue 1

True Blue 2

True Blue 3

DATE STAMP

TELEPHONE SUBMISSION - ACCURACY OF THE ABOVE INFORMATION
IS THE RESPONSIBILITY OF THE CLAIMANT/OWNER

FOR OFFICIAL USE ONLY

2007 AUG 15 A 11:38

RECEIVED
B.L.M. AZ STATE OFFICE

DATE

INITIALS

VERIFIED

COUNT

3

\$ 375

INITIALS

mc

1546770

United States Department of the Interior
Bureau of Land Management
BUSINESS & SUPPORT SVCS DIV
ONE N CENTRAL AVE SUITE 800
PHOENIX, AZ 85004 -4427
Phone: (602) 417-9200

Receipt

No: 1546770

Transaction #: 1598163	
Date of Transaction: 08/17/2007	
CUSTOMER:	KEITH HUGHES BOX 3697 PRESCOTT, AZ 86302

LINE #	QTY	DESCRIPTION	REMARKS	UNIT PRICE	TOTAL
1	1.00	LOCATABLE MINERALS / MINING CLAIMS- NOT NEW-UNADJUD, ONE AUTH NO. ONLY / MINING CLAIM MONEY RECEIVED (455) CASES: AMC330887/\$375.00	MAINT 2008/3	- n/a -	375.00
TOTAL:					\$375.00

PAYMENT INFORMATION				
NOTE: Items will appear on credit card statement as "Bureau of Land Management".				
1	AMOUNT:	\$375.00	POSTMARKED:	N/A
	TYPE:	CREDIT CARD	RECEIVED:	08/17/2007
	NAME:	HUGHES, KEITH BOX 3697 PRESCOTT AZ 86302		
	CARD NO:	XXXXXXXXXXXX1000	AUTH CODE:	109331
	NAME ON CARD:	KEITH HUGHES		
	EXPIRES:	07/31/2009		
	SIGNATURE:			

REMARKS

This receipt was generated by the automated BLM Collections and Billing System and is a paper representation of a portion of the official electronic record contained therein.

UNITED STATES
DEPARTMENT OF THE INTERIOR
BUREAU OF LAND MANAGEMENT

AMC 330887

AMC 328480

CREDIT CARD PAYMENT
FOR MINING CLAIM MAINTENANCE FEE

NAME Keith Hughes

ADDRESS PO Box 3697

CITY Prescott STATE _____ ZIP 86302

PHONE # (928) 710 3545

SEND RECEIPT TO ABOVE ADDRESS ☒

SEND RECEIPT TO: _____

AMC NUMBER

CLAIM/SITE NAME

330887

~~AAA~~ TRUE BLUE #1

330888

TRUE BLUE #2

328480

TRUE BLUE #3

DATE STAMP

TELEPHONE SUBMISSION - ACCURACY OF THE ABOVE INFORMATION
IS THE RESPONSIBILITY OF THE CLAIMANT/OWNER

FOR OFFICIAL USE ONLY

8/25/06

RWE

DATE

INITIALS

VERIFIED

COUNT _____ \$ _____ INITIALS _____

RECEIVED
B.L.M. AZ STATE OFFICE

2006 AUG 21 A 8:53

PHOENIX, ARIZONA

1380952

AMERICAN AIRLINES

SEP 23 10 15 AM '66

RECEIVED
AIRLINE OFFICE
ATLANTA

United States Department of the Interior**Bureau of Land Management**

BUSINESS & SUPPORT SVCS DIV

ONE N CENTRAL AVE

PHOENIX, AZ 85004 -2203

Phone: (602) 417-9200

Receipt

No:

1339151

Transaction #: 1384322**Date of Transaction:** 08/21/2006

CUSTOMER:	KEITH HUGES P O BOX 3697 PRESCOTT, AZ 86302
------------------	---

LINE #	QTY	DESCRIPTION	REMARKS	UNIT PRICE	TOTAL
1	1.00	LOCATABLE MINERALS / MINING CLAIMS-NOT NEW-UNADJUD, ONE AUTH NO. ONLY / MINING CLAIM MONEY RECEIVED (455) CASES: AMC330887/\$375.00	MAINT 2007 (3)	- n/a -	375.00
TOTAL:					\$375.00

PAYMENT INFORMATION

NOTE: Items will appear on credit card statement as "Bureau of Land Management".

1	AMOUNT:	\$375.00	POSTMARKED:	N/A
	TYPE:	CREDIT CARD	RECEIVED:	08/21/2006
	NAME:	HUGES, KEITH P O BOX 3697 PRESCOTT AZ 86302		
	CARD NO:	XXXXXXXXXXXX2012	AUTH CODE:	145792
	NAME ON CARD:	KEITH L HUGES		
	EXPIRES:	07/31/2010		
	SIGNATURE:			

REMARKS

This receipt was generated by the automated BLM Collections and Billing System and is a paper representation of a portion of the official electronic record contained therein.

AU TRUE BLUE L.L.C.
KEITH L. HUGHES
P.O. BOX 3697
PRESCOTT, ARIZONA 86302

330887

328480

BUREAU OF LAND MANAGEMENT
222 N. CENTRAL AVE.
PHOENIX, ARIZONA 85004-2203

AUGUST 10, 2005

ATTN: PUBLIC ROOM
MINING CLAIMS DEPT.

I AM ENCLOSING \$375.00 TO PAY THE MAINTAINENCE FEES ON THE
FOLLOWING 3 CLAIMS.

AMC 330887 THRU AMC 330888, TRUE BLUE #1 AND #2 AND AMC 328480,
TRUE BLUE #3

THE CLAIMS ARE SITUATED IN LA PAZ COUNTY, ARIZONA.

LEGAL R 14 W, T 5 N, SEC 9, SW ¼

THANK-YOU FOR YOUR HELP.

SINCERELY,

Keith L. Hughes

KEITH L. HUGHES
(928) 710-3545

ENTERED INTO COMPUTER

AUG 18 2005 PB

RECEIVED
BUREAU OF
LAND MANAGEMENT
2005 AUG 12 P 1:18
ARIZONA
STATE OFFICE
PHOENIX, ARIZONA

United States Department of the Interior
Bureau of Land Management
BUSINESS & SUPPORT SVCS DIV
222 N CENTRAL AVE
PHOENIX, AZ 85004 -2203
Phone: (602) 417-9200

Receipt

No:

1129554

Transaction #: 1168582

Date of Transaction: 08/16/2005

ENTERED INTO COMPUTER
AUG 18 2005 *fb*

CUSTOMER: KEITH L HUGHES
HUGHES DEVELOPMENT
P O BOX 3697
PRESCOTT, AZ 86302

LINE #	QTY	DESCRIPTION	REMARKS	UNIT PRICE	TOTAL
1	1.00	LOCATABLE MINERALS / MINING CLAIMS-NOT NEW-UNADJUD, ONE AUTH NO. ONLY / MINING CLAIM MONEY RECEIVED (455) CASES: AMC330887/\$375.00	MAINT 2006 (3)	- n/a -	375.00
TOTAL:					\$375.00

PAYMENT INFORMATION			
1	AMOUNT:	\$375.00	POSTMARKED: 08/11/2005
	TYPE:	CHECK	RECEIVED: 08/12/2005
	CHECK NO:	1129	
	NAME:	HUGHES DEVELOPMT P O BOX 3697 PRESCOTT AZ 86302	

REMARKS

This receipt was generated by the automated BLM Collections and Billing System and is a paper representation of a portion of the official electronic record contained therein.

3 sc
Amc 330887
328480

AU TRUE BLUE L.L.C.
KEITH L. HUGHES
P.O. BOX 3697
PRESCOTT, ARIZONA 86302

BUREAU OF LAND MANAGEMENT
222 N. CENTRAL AVE. Suite 101
PHOENIX, ARIZONA 85004-2203

AUGUST 10, 2004

ATTN: PUBLIC ROOM
MINING CLAIMS DEPT.

I AM ENCLOSING \$375.00 TO PAY THE MAINTAINENCE FEES ON THE
FOLLOWING 3 CLAIMS.

AMC 330887 THRU AMC 330888, TRUE BLUE #1 AND #2 AND AMC 328480,
TRUE BLUE #3

THE CLAIMS ARE SITUATED IN LA PAZ COUNTY, ARIZONA.

LEGAL R 14 W, T 5 N, SEC 9, SW ¼

THANK-YOU FOR YOUR HELP.

SINCERELY,

Keith L. Hughes

KEITH L. HUGHES
(928) 710-3545

RECEIVED
BUREAU OF
LAND MANAGEMENT
2004 AUG 13 A 9:45
ARIZONA
STATE OFFICE
PHOENIX, ARIZONA

ENTERED INTO COMPUTER

D 10/14/04

United States Department of the Interior
Bureau of Land Management
BUSINESS & SUPPORT SVCS DIV
222 N CENTRAL AVE
PHOENIX, AZ 85004 -2203
Phone: (602) 417-9200

Receipt

No:

928135

Transaction #: 962332**Date of Transaction:** 08/13/2004

CUSTOMER: KEITH L HUGHES
P O BOX 3697
PRESCOTT, AZ 86302

LINE #	QTY	DESCRIPTION	REMARKS	UNIT PRICE	TOTAL
1	1.00	LOCATABLE MINERALS / MINING CLAIMS-NOT NEW-UNADJUD, ONE AUTH NO. ONLY / MINING CLAIM MONEY RECEIVED (455) CASES: AMC330887/\$375.00	MAINT 2005 (3)	- n/a -	375.00
TOTAL:					\$375.00

PAYMENT INFORMATION

1	AMOUNT:	\$375.00	POSTMARKED:	08/12/2004
	TYPE:	CHECK	RECEIVED:	08/13/2004
	CHECK NO:	1099		
	NAME:	HUGHES DEVELOPMENT P O BOX 3697 PRESCOTT AZ 86302		

REMARKS

This receipt was generated by the automated BLM Collections and Billing System and is a paper representation of a portion of the official electronic record contained therein.

AU TRUE BLUE L.L.C.

MARVIN HUGHES
PO BOX 3697
PRESCOTT AZ 86302
928-708-9983

BUREAU of LAND MANAGEMENT
222 N. CENTRAL AVE.
PHOENIX, AZ 85004-2203

AUGUST 8, 2003

ATTN: PUBLIC ROOM
MINNING CLAIMS DEPT.

AMC 328480

AMC 330887

I AM ENCLOSING \$300.00 TO PAY THE MAINTAINENCE FEES ON THE
FOLLOWING 3 CLAIMS:

AMC 330887 THRU AMC 330888, TRUE BLUE #1 AND # 2 AND AMC 328480,
TRUE BLUE #3

THE CLAIMS ARE SITUATED IN LA PAZ COUNTY, ARIZONA.

LEGAL R 14 W, T 5 N, SEC 9, SW ¼.

THANK YOU FOR YOUR HELP.

SINCERELY,

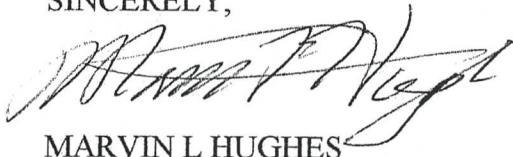

MARVIN L HUGHES

ARIZONA
STATE OFFICE
PHOENIX, ARIZONA

2003 AUG 12 A 11:25

RECEIVED
BUREAU OF
LAND MANAGEMENT

ENTERED IN COMPUTER
RE 9/12/03



**United States Department of the Interior
Bureau of Land Management**

BUSINESS & SUPPORT SVCS DIV

222 N CENTRAL AVE

PHOENIX, AZ 85004 -2203

Phone: (602) 417-9200

Receipt

No:

730117

Transaction #: 759539

Date of Transaction: 08/14/2003

CUSTOMER: AU TRUE BLUE LLC
PO BOX 3697
PRESCOTT, AZ 86302

LINE #	QTY	DESCRIPTION	REMARKS	UNIT PRICE	TOTAL
1	1.00	LOCATABLE MINERALS / MINING CLAIMS-NOT NEW-UNADJUD, ONE AUTH NO. ONLY / MINING CLAIM MONEY RECEIVED (455) CASES: AMC330887/\$300.00	MAINT 2004 (3)	- n/a -	300.00
TOTAL:					\$300.00

PAYMENT INFORMATION

1	AMOUNT:	\$300.00	POSTMARKED:	08/11/2003
	TYPE:	CHECK	RECEIVED:	08/13/2003
	CHECK NO:	165		
	NAME:	HUGHES AND HUGHES PO BOX 3697 PRESCOTT AZ 86302		

REMARKS

This receipt was generated by the automated BLM Collections and Billing System and is a paper representation of a portion of the official electronic record contained therein.

INS No. 56N1117

LEAD FILE #'S

Amc 328480, 330887

[illegible]

Date of Doc 8/8/02

Date of Rec't 8/8/02

Amount Rec'd 3000.00

Amount Earned 300.00

480 POL
481 NOI
482 MAINT
396 TRANS
635 AMEND

[illegible]

Date Entered: 8/03/02

Date Verified: 9/17/02 AB

Sent to Accts: _____

Date Earned:

NOTES:

AU TRUE BLUE L.L.C.

MARVIN HUGHES
PO BOX 3697
PRESCOTT AZ 86302
928-708-9983

BUREAU of LAND MANAGEMENT
222 N. CENTRAL AVE
PHOENIX, AZ 85004-2203

ATTN: PUBLIC ROOM
MINING CLAIMS DEPT

I AM ENCLOSING \$300.00 TO PAY THE MAINTAINENCE FEES ON THE
FOLLOWING 3 CLAIMS:

AMC 330887 THRU AMC 330888, TRUE BLUE #1 AND # 2 AND AMC 328480,
TRUE BLUE #3

THE CLAIMS ARE SITUATED IN LA PAZ COUNTY, ARIZONA.

LEGAL R 14 W, T 5 N, SEC 9, SW ¼.

THANK YOU FOR YOUR HELP.

SINCERELY,



MARVIN L. HUGHES

ARIZONA
STATE OFFICE
PHOENIX, ARIZONA

2002 AUG - 8 A 10:42

RECEIVED
BUREAU OF
LAND MANAGEMENT

8/23/02
ENTERED INTO COMPUTER

United States Department of the Interior
Bureau of Land Management
BUSINESS & SUPPORT SVCS DIV
222 N CENTRAL AVE
PHOENIX, AZ 85004 -2203
Phone: (602) 417-9200

Receipt

No:

536265

Transaction #: 560667

Date of Transaction: 08/08/2002

CUSTOMER: AU TRUE BLUE LLC
PO BOX 3697
PRESCOTT, AZ 86302

LINE #	QTY	DESCRIPTION	REMARKS	UNIT PRICE	TOTAL
1	1.00	LOCATABLE MINERALS / MINING CLAIMS-NOT NEW-UNADJUD, ONE AUTH NO. ONLY / MINING CLAIM MONEY RECEIVED (455) CASES: AMC328480/\$300.00	MAINT 2003 (3)	- n/a -	300.00
TOTAL:					\$300.00

PAYMENT INFORMATION					
1	AMOUNT:	\$300.00		POSTMARKED:	08/07/2002
	TYPE:	CHECK		RECEIVED:	08/08/2002
	CHECK NO:	959			
	NAME:	HUGHES, MARVIN L PO BOX 3697 PRESCOTT AZ 86302			

REMARKS

This receipt was generated by the automated BLM Collections and Billing System and is a paper representation of a portion of the official electronic record contained therein.

Trans No. 369207

330887, 328480

Date of Doc 8-6-01
Date of Rec't 8-6-01
Amount Rec'd 300.00
Amount Earned _____

480 POL
481 NOI
482 MAINT
396 TRANS
635 AMEND

Date Entered: 10-15-01 KH

Date Verified: _____

Sent to Accts: _____

Date Earned: _____

NOTES:

AU TRUE BLUE L.L.C.
MARVIN HUGHES
P.O. BOX 3697
PRESCOTT, AZ. 86302
520 708-9983

RECEIVED
BUREAU OF
LAND MANAGEMENT

2001 AUG -6 P 2:02

ARIZONA
STATE OFFICE
PHOENIX, ARIZONA

BUREAU OF LAND MANAGEMENT
222 N. CENTRAL AVE.
PHOENIX, AZ. 85004-2203

8/2/01

ATTEN: PUBLIC ROOM
MINING CLAIMS DEPT.

I AM ENCLOSING \$300.00 TO PAY THE MAINTAINENCE FEES ON THE
FOLLOWING 3 CLAIMS:

AMC 330887 THRU AMC 330888, TRUE BLUE #1 AND #2 AND
AMC 328480, TRUE BLUE #3.

THE CLAIMS ARE SITUATED IN LA PAZ COUNTY, ARIZONA.

LEGAL: R 14 W, T 5 N, SEC 9, SW 1/4.

THANK YOU FOR YOUR HELP.

SINCERELY,

MARVIN L. HUGHES

United States Department of the Interior
Bureau of Land Management
BUSINESS & SUPPORT SVCS DIV
222 N CENTRAL AVE
PHOENIX, AZ 85004 -2203
Phone: (602) 417-9200

Receipt

No:

351072

Transaction #: 369207

Date of Transaction: 08/06/2001

CUSTOMER: HUGHES DEVELOPMENT
PO BOX 3697
PRESCOTT, AZ 86302

LINE #	QTY	COMMODITY / SUBJECT / ACTION / PRODUCT	REMARKS	UNIT PRICE	TOTAL
1	1.00	LOCATABLE MINERALS / MINING CLAIMS-NOT NEW-UNADJUD, ONE AUTH NO. ONLY / MINING CLAIM MONEY RECEIVED (455)	MAINT 2002 (3)	- n/a -	\$300.00
TOTAL:					\$300.00

PAYMENT INFORMATION

1	AMOUNT:	\$300.00	POSTMARKED:	N/A
	TYPE:	CHECK	RECEIVED:	08/06/2001
	CHECK NO:	3156		
	NAME:	HUGHES DEVELOPMENT PO BOX 3697 PRESCOTT AZ 86302		

REMARKS

PHONE: SEE DOC

CASE SERIAL NUMBER INFORMATION

TRNS #	LINE #	CASES
369207	1	AMC330887/\$300.00

This receipt was generated by the automated BLM Collections and Billings System and is a paper representation of a portion of the official electronic record contained therein.

ENTERED INTO COMPUTER

10-15-01 KH

Receipt #: 171679

Lead #: 330887, 328480

Amount Received: 300.00

Date: 8/18/00

Transaction #: 184832

[illegible]

Total: 360

480----POL-----\$5

481---NOI-----\$5

482---Maint.---\$100

396---Trf.-----\$5

635----Amd.-----\$5

379----Refund

[illegible]

Entered: 22 AUG 2000
Date

Verified: Sc 08-23-00
Date

Sent to Accounts: 8-23-00
Date

Earned by Accounts: _____
Date _____

FROM : HUGHES ----

PHONE NO. : 760 948 5720

AUG. 14 2000 03:15PM P2

AU TRUE BLUE LLC
Marvin L. Hughes
17524 Lilac St.
Hesperia, CA 92345

August 11, 2000

BUREAU OF LAND MANAGEMENT
222 N. Central Ave.
Phoenix, AZ 85004-2203

Attn: Claims Department

I am enclosing \$300.00 to pay the maintenance fee on the following claims:

330888
AMC 330887 THRU AMC ~~33088~~³³⁰⁸⁸⁸, TRUE BLUE ~~#1~~³ AND ~~#2~~³
AMC 328480, TRUE BLUE ~~#2~~¹.

The claims are situated in La Paz County, Arizona.

LEGAL: R 14 W, T 5 N, SEC 9, SW 1/4

Thank you for your help.

Sincerely,

Marvin L. Hughes

Marvin L. Hughes

ENTERED INTO COMPUTER

22 AUG 2000

VERIFIED

✓ P-23-02

RECEIVED
BUREAU OF
LAND MANAGEMENT
PHOENIX, ARIZONA

AUG 18 11 01 AM '00

An incorrect serial number(s) was used when your Maintenance Fee Payment Waiver Certification was filed. The correct numbers are as noted on this copy. Please use the correct serial number(s) on all future correspondence to insure that the correct mining claims are updated on the official records. Thank you.

United States Department of the Interior
Bureau of Land Management
BUSINESS & SUPPORT SVCS DIV
222 N CENTRAL AVE
PHOENIX, AZ 85004 -2203
Phone: (602) 417-9200

Receipt

No:

171679

Transaction #: 184832

Date of Transaction: 08/18/2000

CUSTOMER: MARVIN HUGHES
17524 LILAC ST
HESPERIA, CA 92345

LINE #	QTY	COMMODITY / SUBJECT / ACTION / PRODUCT	REMARKS	UNIT PRICE	TOTAL
1	1	LOCATABLE MINERALS / MINING CLAIMS-ACCOUNTS/UNADJUDICATED / MINING CLAIM MONEY RECEIVED (455)	MAINT 2001 (3)	- n/a -	\$300.00
TOTAL:					\$300.00

PAYMENT INFORMATION

1	AMOUNT:	\$300.00	POSTMARKED:	08/17/2000
	TYPE:	CHECK	RECEIVED:	08/18/2000
	CHECK NO:	008485		
	NAME:	AU TRUE BLUE LLC 17524 LILAC ST HESPERIA CA 92345		

REMARKS

CASE SERIAL NUMBER INFORMATION

TRNS #	LINE #	CASES
184832	1	AMC330887

This receipt was generated by the automated BLM Collections and Billings System and is a paper representation of a portion of the official electronic record contained therein.

330887
328480

AU TRUE BLUE L.L.C.
MARVIN L. HUGHES
17524 LILAC STREET
HESPERIA, CA. 92345
August, 10, 1999

BUREAU OF LAND MANAGEMENT
222 N. Central Ave.
Pheonix, Az. 85004-2203

Attn: Claims Department

I am enclosing \$300.00 to pay the maintainence fee on the following claims:

AMC 330887 THRU AMC 330888, TRUE BLUE #1 AND #2
AMC 328480, TRUE BLUE #3

The claims are situated in La Paz County, Arizona.

LEGAL: R 14 W, T 5 N, SEC 9, SW 1/4

Thank you for your help.

Sincerely,

Marvin L. Hughes

RECEIVED
B.L.M. AZ STATE OFFICE
1999 AUG 16 P 1:23
PHOENIX, ARIZONA

VERIFIED

TRX
10-14-99

ENTERED INTO COMPUTER

SB 8/25/99

UNITED STATES
DEPARTMENT OF THE INTERIOR
BUREAU OF LAND MANAGEMENT

RECEIPT AND ACCOUNTING ADVICE

NO. 2296577 07

CD/AZ

08/16/99

Subject:

CLAIM MAINTENANCE FEE 2000

2 16 13

300.00

Applicant:

AU TRUE BLUE LLC
MARVIN L HUGHES
17524 LILAC ST
HESPERIA CA 92345

Remitter: CK 6563

Assignor:

LEASE MANAGEMENT DATA										
<input type="checkbox"/> NEW <input type="checkbox"/> UPDATE <input type="checkbox"/> PAYMENT										
ORIGINAL SERIAL NO.	ASG.	TYPE	ST.	CTY.	FUND SYMBOL				ACRES/UNITS	RATE
AMC 330887 ET AL	(3)									
AMOUNT	ANV. DATE	EXP. DATE	BILL CYC.	S/C	DISTRICT	NEXT BILL	MISC. DATA	U of M	ACTUAL UNITS	
ASSIGNMENT SERIAL NO.	ASG.	TYPE	ST.	CTY.	FUND SYMBOL				ACRES/UNITS	RATE
AMOUNT	ANV. DATE	EXP. DATE	BILL CYC.	S/C	DISTRICT	NEXT BILL	MISC. DATA	U of M	ACTUAL UNITS	
APPLY REMITTANCE										
ACTION	FUND SYMBOL				CTY.	AMOUNT				
FILING FEE										
RENTAL										
UNEARNED										
REFUND										
TOTAL										
AMOUNT DUE										
<input type="checkbox"/> Lease in Escrow? <input type="checkbox"/> KGS? <input type="checkbox"/> Auto Escalates? <input type="checkbox"/> Auto Renew?						FOR MMS USE ONLY				
						BILLEE		FOREST REFUGE		
						NUMBER				
						OCS SECTION				
						CODE				

Remarks:

BY:

DATE:

330887
328480

A U TRUE BLUE L.L.C.
MARVIN L. HUGHES
17524 LILAC STREET
HESPERIA, CA. 92345
August 17, 1998

RECEIVED
BUREAU OF
LAND MANAGEMENT
AUG 18 9 15 AM '98
ARIZONA
STATE OFFICE
CHANDLER, ARIZONA

BUREAU of LAND MANAGEMENT
222 N. Central Ave.
Pheonix, az. 85004-2203

Attn: Claims Department

I am enclosing \$300.00 to pay the maintainence fee on the following claims:

AMC 330887 THRU AMC 330888 TRUE BLUE #1 AND #2
AMC 328480 TRUE BLUE #3

The claims are situated in La Paz County, Arizona.

LEGAL: R 14 W, T 5 N, SEC 9, SW 1/4

Thank you for your help.

Sincerely,

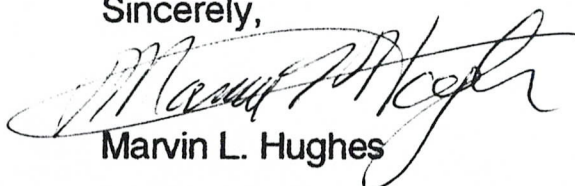
Marvin L. Hughes

ENTERED IN COMPUTER VERIFIED

SB 8/20/98

SEP 21 1998

3

170-41
(March 1984)

UNITED STATES
DEPARTMENT OF THE INTERIOR
BUREAU OF LAND MANAGEMENT

RECEIPT AND ACCOUNTING ADVICE

NO. 2389429 04

TC/AZ

08/18/98

Subject: CLAIM MAINTENANCE FEE 1999 - 3

2 32 13

300.00 -

Applicant:

K L H CONSTRUCTION
17524 LILAC ST
HESPERIA CA 92345

CK 022792

Remitter: 760 948-3241

Assignor:

LEASE MANAGEMENT DATA										<input type="checkbox"/> NEW	<input type="checkbox"/> UPDATE	<input type="checkbox"/> PAYMENT
ORIGINAL SERIAL NO.	ASG.	TYPE	ST.	CTY.	FUND SYMBOL				ACRES/UNITS	RATE		
AMC 328480, ET AL												
AMOUNT	ANV. DATE	EXP. DATE	BILL CYC.	S/C	DISTRICT	NEXT BILL	MISC. DATA	U of M	ACTUAL UNITS			
ASSIGNMENT SERIAL NO.	ASG.	TYPE	ST.	CTY.	FUND SYMBOL				ACRES/UNITS	RATE		
AMOUNT	ANV. DATE	EXP. DATE	BILL CYC.	S/C	DISTRICT	NEXT BILL	MISC. DATA	U of M	ACTUAL UNITS			
APPLY REMITTANCE										Remarks:		
ACTION	FUND SYMBOL		CTY.	AMOUNT								
FILING FEE												
RENTAL												
UNEARNED												
REFUND												
TOTAL												
AMOUNT DUE												
<input type="checkbox"/> Lease in Escrow? <input type="checkbox"/> KGS? <input type="checkbox"/> Auto Escalates? <input type="checkbox"/> Auto Renew?										BY: DATE:		
Of Interest? Operating Rights? Operator Bond Filed?										FOR MMS USE ONLY		
										BILLEE	FOREST REFUGE	
										NUMBER		
										OCS SECTION		
										CODE		

CASE FOLDER COPY

RECEIVED
BUREAU OF
LAND MANAGEMENT

AUG 27 10 12 AM '97

ARIZONA
STATE OFFICE
PHOENIX, ARIZONA

A U TRUE BLUE L.L.C.
MARVIN L. HUGHES
17524 LILAC STREET
HESPERIA, CA. 92345
AUGUST 26, 1997

Amc 330887
Amc 328480
ERS

BUREAU OF LAND MANAGEMENT
222 N. CENTRAL AVE.
PHOENIX, AZ. 85004-2203

ATTN. CLAIMS DEPARTMENT

I AM INCLUDING \$300.00 TO PAY THE MAINTAINANCE FEE ON THE
FOLLOWING CLAIMS:

A MC 330887 THRU A MC 330888 TRUE BLUE #1 & #2
A MC 328480 TRUE BLUE #3

THE CLAIMS ARE SITUATED IN LA PAZ COUNTY, ARIZ.

LEGAL: R 14 W, T 5 N, SEC 9, SW 1/4

THANK YOU FOR YOUR HELP.

SINCERELY

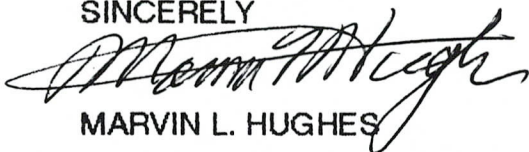
MARVIN L. HUGHES

ENTERED IN COMPUTER
SEP 16 1997 ERS

VERIFIED
10/22/97 ERS

UNITED STATES
DEPARTMENT OF THE INTERIOR
BUREAU OF LAND MANAGEMENT

RECEIPT AND ACCOUNTING ADVICE

NO. 2372690 04

TC/AZ

08/27/97

Subject: CLAIM MAINTENANCE FEE 1998 - 3

2 52 13

300.00

Applicant:

MARVIN HUGHES
17524 LILAC ST
HESPERIA CA 92345

Remitter: CK 420
948-3241

Assignor:

LEASE MANAGEMENT DATA											
<input type="checkbox"/> NEW <input type="checkbox"/> UPDATE <input type="checkbox"/> PAYMENT											
ORIGINAL SERIAL NO.	ASG.	TYPE	ST.	CTY.	FUND SYMBOL				ACRES/UNITS	RATE	
AMC 330887, ET AL											
AMOUNT	ANV. DATE	EXP. DATE	BILL CYC.	S/C	DISTRICT	NEXT BILL	MISC. DATA	U of M	ACTUAL UNITS		
ASSIGNMENT SERIAL NO.	ASG.	TYPE	ST.	CTY.	FUND SYMBOL				ACRES/UNITS	RATE	
AMOUNT	ANV. DATE	EXP. DATE	BILL CYC.	S/C	DISTRICT	NEXT BILL	MISC. DATA	U of M	ACTUAL UNITS		
APPLY REMITTANCE										Remarks:	
ACTION	FUND SYMBOL		CTY.	AMOUNT							
FILING FEE											
RENTAL											
UNEARNED											
REFUND											
TOTAL											
AMOUNT DUE											
<div><input type="checkbox"/> Lease in Escrow? <input type="checkbox"/> KGS? <input type="checkbox"/> Auto Escalates? <input type="checkbox"/> Auto Renew?</div> <div><input type="checkbox"/> Of Interest? <input type="checkbox"/> Operating Rights? <input type="checkbox"/> Operator <input type="checkbox"/> Bond Filed?</div>										BY: _____ DATE: _____	
FOR MMS USE ONLY											
BILLEE							FOREST REFUGE				
NUMBER											
OCS SECTION											
CODE											

MAINTENANCE FEE PAYMENT

\$100.00 MAINTENANCE FEE PAYMENT DUE ON OR BEFORE AUGUST 31, 1996
IN LIEU OF ASSESSMENT WORK FOR THE UPCOMING ASSESSMENT
YEAR BEGINNING SEPTEMBER 1 OF THE YEAR NOTED ABOVE.

BUREAU OF LAND MANAGEMENT
ARIZONA STATE OFFICE
3707 NORTH 7TH STREET
PHOENIX, AZ 85014 (OR)
P.O. BOX 16563, PHOENIX, AZ 85011

<u>330887</u>		
<u>328480</u>		
COUNT: <u>3</u>	\$ <u>300</u>	INT: <u>00</u>
FOR OFFICIAL USE ONLY		

THE CLAIMS ARE SITUATED IN LA PAZ COUNTY,
ARIZONA.

BLM SERIAL NUMBERS

NAMES OF CLAIMS OR SITES

A MC 330887 THRU A MC 330888 TRUE BLUE + TRUE BLUE #3

COUNTY BOOK/DOCKET _____, PAGE(S) OR FEE NO(S) _____

A MC 328480 THRU A MC _____ TRUE BLUE #1

COUNTY BOOK/DOCKET _____, PAGE(S) OR FEE NO(S) _____

(OR) IF NOT CONSECUTIVE NUMBERS LIST SEPARATELY BELOW:

BLM SERIAL NUMBERS	NAME OF CLAIMS/SITES	COUNTY BOOK/DOCKET & PAGE OR FEE NUMBER
A MC <u>330887</u>	<u>TRUE BLUE</u>	_____
A MC <u>328480</u>	<u>TRUE BLUE #1</u>	_____
A MC <u>330888</u>	<u>TRUE BLUE #3</u>	_____
A MC _____	_____	_____
A MC _____	_____	_____
A MC _____	_____	_____
A MC _____	_____	_____
A MC _____	_____	_____
A MC _____	_____	_____
A MC _____	_____	_____
A MC _____	_____	_____

CLAIMANT'S NAME: AN TRUE BLUE LLC.

ADDRESS: 5800 W SARAGOSA ST CITY: CHANDLER STATE: AZ

☐ CHECK HERE IF THIS IS A CHANGE OF ADDRESS PHONE: (602) 940-3392 ZIP: 85226

SIGNATURE: Charles W Smith
TO RECORD WITH THE COUNTY, ONE CLAIMANT OR THE AGENT MUST SIGN

LIST ALL ADDITIONAL OWNERS ON REVERSE SIDE OF THIS FORM

FOR OFFICIAL USE ONLY		
ENTERED INTO COMPUTER: _____	SEP 19 1996	<u>JS</u>
DATE	INITIALS	VERIFIED

TIME STAMP
RECEIVED
AUG 19 10 42 AM '96
PHOENIX, ARIZONA

43 CFR 3833.0-5(e) (August 30, 1994) REQUIRES THAT THE NAMES OF ALL OF THE OWNERS AND THEIR CURRENT ADDRESSES SHALL BE IDENTIFIED ON ALL INSTRUMENTS REQUIRED TO BE RECORDED OR FILED BY THE REGULATIONS, 43 CFR SUBPART 3833.

CLAIMANT'S NAME: _____

ADDRESS: _____ CITY: _____ STATE: _____

☐ CHECK HERE IF THIS IS CHANGE OF ADDRESS PHONE: () _____ ZIP: _____

CLAIMANT'S NAME: _____

ADDRESS: _____ CITY: _____ STATE: _____

☐ CHECK HERE IF THIS IS CHANGE OF ADDRESS PHONE: () _____ ZIP: _____

CLAIMANT'S NAME: _____

ADDRESS: _____ CITY: _____ STATE: _____

☐ CHECK HERE IF THIS IS CHANGE OF ADDRESS PHONE: () _____ ZIP: _____

CLAIMANT'S NAME: _____

ADDRESS: _____ CITY: _____ STATE: _____

☐ CHECK HERE IF THIS IS CHANGE OF ADDRESS PHONE: () _____ ZIP: _____

CLAIMANT'S NAME: _____

ADDRESS: _____ CITY: _____ STATE: _____

☐ CHECK HERE IF THIS IS CHANGE OF ADDRESS PHONE: () _____ ZIP: _____

CLAIMANT'S NAME: _____

ADDRESS: _____ CITY: _____ STATE: _____

☐ CHECK HERE IF THIS IS CHANGE OF ADDRESS PHONE: () _____ ZIP: _____

CLAIMANT'S NAME: _____

ADDRESS: _____ CITY: _____ STATE: _____

☐ CHECK HERE IF THIS IS CHANGE OF ADDRESS PHONE: () _____ ZIP: _____

UNITED STATES
DEPARTMENT OF THE INTERIOR
BUREAU OF LAND MANAGEMENT

RECEIPT AND ACCOUNTING ADVICE

NO. **2228351**

04

TC/AZ

08/19/96

Subject: CLAIM MAINTENANCE FEE 1997 (3) 2 21 13 300.00

Applicant: SMITH CONSULTING, INC.
5800 W. SARAGOSA ST.
CHANDLER, AZ 85226

Remitter: SAME AS CK. #1711
602-940-3392

Assignor:

LEASE MANAGEMENT DATA									
<input type="checkbox"/> NEW <input type="checkbox"/> UPDATE <input type="checkbox"/> PAYMENT									
ORIGINAL SERIAL NO.	ASG.	TYPE	ST.	CTY.	FUND SYMBOL			ACRES/UNITS	RATE
AMC 330887 ET AL									
AMOUNT	ANV. DATE	EXP. DATE	BILL CYC.	S/C	DISTRICT	NEXT BILL	MISC. DATA	U of M	ACTUAL UNITS
ASSIGNMENT SERIAL NO.	ASG.	TYPE	ST.	CTY.	FUND SYMBOL			ACRES/UNITS	RATE
AMOUNT	ANV. DATE	EXP. DATE	BILL CYC.	S/C	DISTRICT	NEXT BILL	MISC. DATA	U of M	ACTUAL UNITS
APPLY REMITTANCE									
ACTION	FUND SYMBOL		CTY.	AMOUNT					
FILING FEE									
RENTAL									
UNEARNED									
REFUND									
TOTAL									
AMOUNT DUE									
				Remarks: AMC 330887 328480 330888					
				BY: DATE:					
<input type="checkbox"/> Lease in Escrow? <input type="checkbox"/> KGS? <input type="checkbox"/> Auto Escalates? <input type="checkbox"/> Auto Renew?				FOR MMS USE ONLY BILLEE NUMBER OCS SECTION CODE FOREST REFUGE					

MAINTENANCE FEE PAYMENT

\$100.00 MAINTENANCE FEE PAYMENT DUE ON OR BEFORE AUGUST 31, 19____
IN LIEU OF ASSESSMENT WORK FOR THE UPCOMING ASSESSMENT
YEAR BEGINNING SEPTEMBER 1 OF THE YEAR NOTED ABOVE.

BUREAU OF LAND MANAGEMENT
ARIZONA STATE OFFICE
3707 NORTH 7TH STREET
PHOENIX, AZ 85014 (OR)
P.O. BOX 16563, PHOENIX, AZ 85011

THE CLAIMS ARE SITUATED IN LA PAZ COUNTY,
ARIZONA.

COUNT: 12 \$ 1200.00 INT: JA
FOR OFFICIAL USE ONLY

BLM SERIAL NUMBERS

NAMES OF CLAIMS OR SITES

A MC 330887 THRU A MC 330888 TRUE BLUE #142 ✓

COUNTY BOOK/DOCKET _____, PAGE(S) OR FEE NO(S) _____

A MC 334090 THRU A MC 334698 GOLD CARBON 1-9 ✓

COUNTY BOOK/DOCKET _____, PAGE(S) OR FEE NO(S) _____

(OR) IF NOT CONSECUTIVE NUMBERS LIST SEPARATELY BELOW:

BLM SERIAL NUMBERS	NAME OF CLAIMS/SITES	COUNTY BOOK/DOCKET & PAGE OR FEE NUMBER
A MC <u>328480</u>	<u>TRUE BLUE #3</u>	✓
A MC _____	<u>GOLD CARBON</u>	
A MC _____		
A MC _____		
A MC _____		
A MC _____		
A MC _____		
A MC _____		
A MC _____		
A MC _____		

12/18/96
Not entered into computer
See attached acct.
confirm for application
H M

CLAIMANT'S NAME: MARVIN L. HUGHES

ADDRESS: 17524 Lilac Street CITY: Hesperia STATE: CA

PHONE: (619) 946-3241 ZIP: 92345

☒ CHECK HERE IF THIS
IS A CHANGE OF ADDRESS

SIGNATURE: _____
TO RECORD WITH THE COUNTY, ONE CLAIMANT OR THE AGENT MUST SIGN

LIST ALL ADDITIONAL OWNERS ON REVERSE SIDE OF THIS FORM

FOR OFFICIAL USE ONLY
ENTERED INTO COMPUTER: _____
DATE INITIALS VERIFIED

TIME STAMP

43 CFR 3833.0-5(e) (August 30, 1994) REQUIRES THAT THE NAMES OF ALL OF THE OWNERS AND THEIR CURRENT ADDRESSES SHALL BE IDENTIFIED ON ALL INSTRUMENTS REQUIRED TO BE RECORDED OR FILED BY THE REGULATIONS, 43 CFR SUBPART 3833.

CLAIMANT'S NAME: _____

ADDRESS: _____ CITY: _____ STATE: _____

☐ CHECK HERE IF THIS IS CHANGE OF ADDRESS PHONE: () ZIP: _____

CLAIMANT'S NAME: _____

ADDRESS: _____ CITY: _____ STATE: _____

☐ CHECK HERE IF THIS IS CHANGE OF ADDRESS PHONE: () ZIP: _____

CLAIMANT'S NAME: _____

ADDRESS: _____ CITY: _____ STATE: _____

☐ CHECK HERE IF THIS IS CHANGE OF ADDRESS PHONE: () ZIP: _____

CLAIMANT'S NAME: _____

ADDRESS: _____ CITY: _____ STATE: _____

☐ CHECK HERE IF THIS IS CHANGE OF ADDRESS PHONE: () ZIP: _____

CLAIMANT'S NAME: _____

ADDRESS: _____ CITY: _____ STATE: _____

☐ CHECK HERE IF THIS IS CHANGE OF ADDRESS PHONE: () ZIP: _____

CLAIMANT'S NAME: _____

ADDRESS: _____ CITY: _____ STATE: _____

☐ CHECK HERE IF THIS IS CHANGE OF ADDRESS PHONE: () ZIP: _____

CLAIMANT'S NAME: _____

ADDRESS: _____ CITY: _____ STATE: _____

☐ CHECK HERE IF THIS IS CHANGE OF ADDRESS PHONE: () ZIP: _____

UNITED STATES
DEPARTMENT OF THE INTERIOR
BUREAU OF LAND MANAGEMENT

RECEIPT AND ACCOUNTING ADVICE

NO. 2263407

04

Subject: CLAIM MAINTENANCE FEE 1997 - 12 TC/AZ 08/26/96
Applicant: 3 29 53 1,200.00

MARVIN L. HUGHES
17524 LILAC ST
HESPERIA CA 92345

Remitter: SAME AS CC

Assignor:

LEASE MANAGEMENT DATA										<input type="checkbox"/> NEW	<input type="checkbox"/> UPDATE	<input type="checkbox"/> PAYMENT
ORIGINAL SERIAL NO.		ASG.	TYPE	ST.	CTY.	FUND SYMBOL			ACRES/UNITS		RATE	
AMC 330887, ET AL												
AMOUNT	ANV. DATE	EXP. DATE	BILL CYC.	S/C	DISTRICT	NEXT BILL	MISC. DATA	U of M	ACTUAL UNITS			
ASSIGNMENT SERIAL NO.		ASG.	TYPE	ST.	CTY.	FUND SYMBOL			ACRES/UNITS		RATE	
AMOUNT	ANV. DATE	EXP. DATE	BILL CYC.	S/C	DISTRICT	NEXT BILL	MISC. DATA	U of M	ACTUAL UNITS			
APPLY REMITTANCE												
ACTION	FUND SYMBOL					CTY.	AMOUNT					
FILING FEE												
RENTAL												
UNEARNED												
REFUND							1200.00					
TOTAL												
AMOUNT DUE												
<input type="checkbox"/> Lease in Escrow? <input type="checkbox"/> KGS? <input type="checkbox"/> Auto Escalates? <input type="checkbox"/> Auto Renew?							Of Interest? Operating Rights? Operator Bond Filed?					
							FOR MMS USE ONLY					
							BILLEE		FOREST REFUGE			
							NUMBER					
							OCS SECTION					
							CODE					

Remarks:

12/18/96
Refund \$1200.00 previously paid
Receipt # 2228652 - 7/25/96
2228351 8/19/96
BY: *Ann Monahan* DATE: *12/18/96*

MAINTENANCE FEE PAYMENT

\$100.00 MAINTENANCE PAYMENT DUE ON OR BEFORE AUGUST 31, 1996
 IN LIEU OF ASSESSMENT WORK FOR THE UPCOMING ASSESSMENT
 YEAR BEGINNING SEPTEMBER 1 OF THE YEAR NOTED ABOVE.

BUREAU OF LAND MANAGEMENT
 ARIZONA STATE OFFICE
 3707 NORTH 7TH STREET
 PHOENIX, AZ 85014 (OR)
 P.O. BOX 16563, PHOENIX, AZ 85011

330887

328480

COUNT: 3 \$ 300 INT: 00

FOR OFFICIAL USE ONLY

THE CLAIMS ARE SITUATED IN LA PAZ COUNTY,
 ARIZONA.

BLM SERIAL NUMBERS

NAMES OF CLAIMS OR SITES

A MC 330887 THRU A MC 330888 TRUE BLUE + TRUE BLUE #3
 COUNTY BOOK/DOCKET _____, PAGE(S) OR FEE NO(S) _____

A MC 328480 THRU A MC _____ TRUE BLUE #1
 COUNTY BOOK/DOCKET _____, PAGE(S) OR FEE NO(S) _____

(OR) IF NOT CONSECUTIVE NUMBERS LIST SEPARATELY BELOW:

BLM SERIAL NUMBERS	NAME OF CLAIMS/SITES	COUNTY BOOK/DOCKET & PAGE OR FEE NUMBER
A MC <u>330557</u>	<u>TRUE BLUE</u>	_____
A MC <u>328480</u>	<u>TRUE BLUE #1</u>	_____
A MC <u>330888</u>	<u>TRUE BLUE #3</u>	_____
A MC _____	_____	_____
A MC _____	_____	_____
A MC _____	_____	_____
A MC _____	_____	_____
A MC _____	_____	_____
A MC _____	_____	_____
A MC _____	_____	_____

CLAIMANT'S NAME: An TRUE BLUE LLC.

ADDRESS: 5800 W SARAGOSA ST CITY: CHANDLER STATE: AZ

☐ CHECK HERE IF THIS IS A CHANGE OF ADDRESS PHONE: (602) 940-3392 ZIP: 85226

SIGNATURE: Charles W Smith
 TO RECORD WITH THE COUNTY, ONE CLAIMANT OR THE AGENT MUST SIGN

LIST ALL ADDITIONAL OWNERS ON REVERSE SIDE OF THIS FORM

FOR OFFICIAL USE ONLY

ENTERED INTO COMPUTER: _____ DATE: SEP 19 1996 INITIALS: JS VERIFIED: ERS

TIME STAMP

PHOENIX, ARIZONA
 AUG 19 10 42 AM '96

UNITED STATES
DEPARTMENT OF THE INTERIOR
BUREAU OF LAND MANAGEMENT

RECEIPT AND ACCOUNTING ADVICE

NO. **2228351** 04
TC/AZ 08/19/96

Subject: CLAIM MAINTENANCE FEE 1997 (3) 2 21 13 300.00

Applicant: SMITH CONSULTING, INC.
3800 W. SARAGOSA ST.
CHANDLER, AZ 85226

Remitter: SAME AS CK. #1711
602-940-3392

Assignor:

LEASE MANAGEMENT DATA										<input type="checkbox"/> NEW	<input type="checkbox"/> UPDATE	<input type="checkbox"/> PAYMENT
ORIGINAL SERIAL NO.		ASG.	TYPE	ST.	CTY.	FUND SYMBOL			ACRES/UNITS		RATE	
AMC 330887 ET AL												
AMOUNT	ANV. DATE	EXP. DATE	BILL CYC.	S/C	DISTRICT	NEXT BILL	MISC. DATA	U of M	ACTUAL UNITS			
ASSIGNMENT SERIAL NO.		ASG.	TYPE	ST.	CTY.	FUND SYMBOL			ACRES/UNITS		RATE	
AMOUNT	ANV. DATE	EXP. DATE	BILL CYC.	S/C	DISTRICT	NEXT BILL	MISC. DATA	U of M	ACTUAL UNITS			
APPLY REMITTANCE												
ACTION	FUND SYMBOL		CTY.	AMOUNT		Remarks: <i>Amc 328480</i> <i>330887- 330888</i>						
FILING FEE												
RENTAL												
UNEARNED												
REFUND												
TOTAL												
AMOUNT DUE						BY: DATE:						
<input type="checkbox"/> Lease in Escrow? <input type="checkbox"/> KGS? <input type="checkbox"/> Auto Escalates? <input type="checkbox"/> Auto Renew?						FOR MMS USE ONLY						
Of Interest? Operating Rights? Operator Bond Filed?						BILLEE		FOREST REFUGE				
						NUMBER						
						OCS SECTION						
						CODE						

MAINTENANCE FEE PAYMENT

\$100.00 MAINTENANCE FEE PAYMENT DUE ON OR BEFORE AUGUST 31, 1995
IN LIEU OF ASSESSMENT WORK FOR THE UPCOMING ASSESSMENT
YEAR BEGINNING SEPTEMBER 1 OF THE YEAR NOTED ABOVE.

BUREAU OF LAND MANAGEMENT
ARIZONA STATE OFFICE
3707 NORTH 7TH STREET
PHOENIX, AZ 85014 (OR)
P.O. BOX 16563, PHOENIX, AZ 85011

328480
330887
COUNT: 3 \$ 300.00 INT: 12.8
FOR OFFICIAL USE ONLY

THE CLAIMS ARE SITUATED IN LA PAS COUNTY, ARIZONA.

BLM SERIAL NUMBERS

NAMES OF CLAIMS OR SITES

A MC 330887 THRU A MC 330888 True Blue, True Blue III
COUNTY BOOK/DOCKET 1 of 2, PAGE(S) OR FEE NO(S) 94-02773
A MC 328480 THRU A MC 328481 True Blue I
COUNTY BOOK/DOCKET 1 of 2, PAGE(S) OR FEE NO(S) 93-05174

(OR) IF NOT CONSECUTIVE NUMBERS LIST SEPARATELY BELOW:

BLM SERIAL NUMBERS	NAME OF CLAIMS/SITES	COUNTY BOOK/DOCKET & PAGE OR FEE NUMBER
A MC _____	_____	_____
A MC _____	_____	_____
A MC _____	_____	_____
A MC _____	_____	_____
A MC _____	_____	_____
A MC _____	_____	_____
A MC _____	_____	_____
A MC _____	_____	_____
A MC _____	_____	_____
A MC _____	_____	_____

CLAIMANT'S NAME: _____

ADDRESS: 9533 E. DECATUR ST. CITY: MESA STATE: AZ

☐ CHECK HERE IF THIS IS A CHANGE OF ADDRESS PHONE: () 984-9379 ZIP: 82507

SIGNATURE: [Signature]
TO RECORD WITH THE COUNTY, ONE CLAIMANT OR THE AGENT MUST SIGN

LIST ALL ADDITIONAL OWNERS ON REVERSE SIDE OF THIS FORM

FOR OFFICIAL USE ONLY		
ENTERED INTO COMPUTER: <u>9/25/95</u>	DATE	INITIALS
		VERIFIED

TIME STAMP

RECEIVED
B.L.M. AZ STATE OFFICE
Aug 24 11 18 AM '95
PHOENIX, ARIZONA

UNITED STATES
DEPARTMENT OF THE INTERIOR
BUREAU OF LAND MANAGEMENT

RECEIPT AND ACCOUNTING ADVICE

NO.2147865 04

RS/AZ

08/24/95

Subject: CLAIM MAINTENANCE FEE 1996 (3)

1 30 13

300.00

Applicant:

CARL RUSSELL
9533 E. DECATUR ST.
MESA, AZ 85507

Remitter: SAME - CASH
(602) 984-9379

Assignor:

LEASE MANAGEMENT DATA										<input type="checkbox"/> NEW	<input type="checkbox"/> UPDATE	<input type="checkbox"/> PAYMENT
ORIGINAL SERIAL NO.		ASG.	TYPE	ST.	CTY.	FUND SYMBOL			ACRES/UNITS		RATE	
AMD 330887, ET AL												
AMOUNT	ANV. DATE	EXP. DATE	BILL CYC.	S/C	DISTRICT	NEXT BILL	MISC. DATA	U of M	ACTUAL UNITS			
ASSIGNMENT SERIAL NO.		ASG.	TYPE	ST.	CTY.	FUND SYMBOL			ACRES/UNITS		RATE	
AMOUNT	ANV. DATE	EXP. DATE	BILL CYC.	S/C	DISTRICT	NEXT BILL	MISC. DATA	U of M	ACTUAL UNITS			
APPLY REMITTANCE												
ACTION	FUND SYMBOL					CTY.	AMOUNT					
FILING FEE												
RENTAL												
UNEARNED												
REFUND												
TOTAL												
AMOUNT DUE												
<input type="checkbox"/> Lease in Escrow? <input type="checkbox"/> KGS? <input type="checkbox"/> Auto Escalates? <input type="checkbox"/> Auto Renew?							<input type="checkbox"/> Of Interest? <input type="checkbox"/> Operating Rights? <input type="checkbox"/> Operator <input type="checkbox"/> Bond Filed?					
Remarks: rec 8/24 330887 - 8 = 2 328480 = 1/3												
BY: _____ DATE: _____												
FOR MMS USE ONLY												
BILLEE						FOREST REFUGE						
NUMBER												
OCS SECTION												
CODE												

UNEARNED FILE COPY

\$100.00 MAINTENANCE FEE PAYMENT
FOR 1995 IN LIEU OF ASSESSMENT
DUE ON OR BEFORE AUGUST 31, 1994

BUREAU OF LAND MANAGEMENT
ARIZONA STATE OFFICE
3707 N. 7TH STREET
PHOENIX, ARIZONA 85014 (OR)
P. O. BOX 16563, ZIP CODE 85011

AMC 328480
AMC 330887 JR

COUNT: 3 \$ 300.00
FOR OFFICIAL USE ONLY

022

BLM SERIAL NUMBERS

NAMES OF CLAIMS/SITES

AMC _____ THRU AMC _____

AMC _____ THRU AMC _____

AMC _____ THRU AMC _____

(OR) IF NOT CONSECUTIVE NUMBERS, LIST SEPARATELY BELOW:

BLM SERIAL NUMBERS

NAMES OF CLAIMS/SITES

AMC 330887

True Blue ✓

AMC 330888

True Blue #2 ✓

AMC 328480

True Blue #1 ✓

AMC _____

AMC _____

AMC _____

AMC _____

AMC _____

AMC _____

AMC _____

AMC _____

AMC _____

CLAIMANT'S NAME: CARL Russell

ADDRESS: R1 / Box 262 Miami Az.

CITY: Miami

STATE: AZ

PHONE: (602) 473-3212

ZIP: 85539

☐

CHECK HERE IF THIS IS A CHANGE OF ADDRESS.

TIME
STAMP

RECEIVED
BLM AZ STATE OFFICE
JUL 21 1 28 PM '94
PHOENIX, ARIZONA

FOR OFFICIAL USE ONLY

ENTERED INTO COMPUTER: 7-27-94
DATE

JR
INITIALS

8-16-94
E. J. H. VERIFIED

address
checked

UNITED STATES
DEPARTMENT OF THE INTERIOR
BUREAU OF LAND MANAGEMENT

RECEIPT AND ACCOUNTING ADVICE

No. 2061925

Subject:

CLAIM MAINTENANCE FEE 1995 (3)

SM/AZ

07/21/94

1 1 13

300.00

Applicant:

CARL RUSSELL
RT. 1, BOX 262
MIAMI, AZ 85539

Remitter: SAME - CASH

Assignor:

LEASE MANAGEMENT DATA ☐ NEW ☐ UPDATE ☐ PAYMENT

ORIGINAL SERIAL NO.	ASG.	TYPE	ST.	CTY.	FUND SYMBOL	ACRES/UNITS	RATE
AMC 330887, ET AL							

AMOUNT	ANV. DATE	EXP. DATE	BILL CYC.	S/C	DISTRICT	NEXT BILL	MISC. DATA	U of M	ACTUAL UNITS

ASSIGNMENT SERIAL NO.	ASG.	TYPE	ST.	CTY.	FUND SYMBOL	ACRES/UNITS	RATE

AMOUNT	ANV. DATE	EXP. DATE	BILL CYC.	S/C	DISTRICT	NEXT BILL	MISC. DATA	U of M	ACTUAL UNITS

APPLY REMITTANCE			
ACTION	FUND SYMBOL	CTY.	AMOUNT
FILING FEE			
RENTAL			
UNEARNED			
REFUND			
TOTAL			
AMOUNT DUE			

Remarks:

330887-8 } 3
328480 }

BY:

DATE:

☐ Lease in Escrow?☐ KGS?☐ Auto Escalates?☐ Auto Renew?

Of Interest?

Operating Rights?

Operator

Bond Filed?

FOR MMS USE ONLY

BILLEE	FOREST REFUGE
NUMBER	
OCS SECTION	
CODE	

NOTICE!!

These documents have been scanned!

Do not place un-scanned documents beneath this notice!

Do not remove this notice from this file!

GPO Jacket No. 560-102
Print Order 61540
Rise Business Services, LLC
Job=AZ15 7/29/2019



Box Number= AZ15179



Claim Begin-End: AMC330887-AMc330888

5 Miscellaneous



AZ15179-4

AMC330680-AMC330967

UNITED STATES DEPARTMENT OF THE INTERIOR
BUREAU OF LAND MANAGEMENT
ARIZONA STATE OFFICE

IN REPLY REFER TO:
AMC

Memorandum

To: Case File *3284 80*
AMC 330887-88

From: *334690-98*

Subject: Documentation of Telephone Conversation

Name of Person Contacted: *Corra Frudson*

Telephone Number of Person Contacted: *619-948-3241*

Date of Contact: *12/17/94*

Summary: *Left message with Corra Frudson*
to have Maurer Hughes call in reference to
payment of Maestrona for Mary Claims

Steve Morrison

Keith Hughes - son of Maurer called
Rep. Mary Claims. He realized that
they overpaid - just wanted to be sure
that Maestrona was paid for 1997.

NOTICE!!

These documents have been scanned!

Do not place un-scanned documents beneath this notice!

Do not remove this notice from this file!

GPO Jacket No. 560-102
Print Order 61540
Rise Business Services, LLC
Job=AZ15 7/29/2019



Box Number= AZ15179



Claim Begin-End: AMC330887-AMc330888

6 Location Notices-Amendments and Supporting Documents



AZ15179-4

AMC330680-AMC330967

MINING CLAIMS MILL OR TUNNEL SITES STATUS REPORT

**Lead Serial No. A MC 330887 **Township(s) 5N
**Lode Claims 2 **Range(s) 14W
**Placer Claims _____ **Section(s) 9
**Association Placer _____
Not Enough Locators
(Send Form Letter) _____
**Mill Sites _____
**Tunnel Sites _____
**Relocations _____
**Timely Filed (YES) NO **GENERAL JURISDICTION OF:
**Service Charge Correct (YES) NO BLM ✓
**Location Fee Correct (YES) NO National Forest _____
**Maintenance Fee Correct (YES) NO Other _____
**Amount Paid 270 **STATUS CHECKED (Enter Code 669)
Shortage \$ _____ Overage \$ _____ MTP ✓ ORCA ✓ BY TR
**Over-the-Counter ✓ Mail _____ **PRIVATE, STATE, OTHER SURFACE
**Enter Code 880 _____
**Wilderness Area _____

STATUS

**CLAIMS PARTIALLY VOID: Fee _____ Withdrawn _____ Other _____

**CLAIMS VOID: Fee _____ Withdrawn _____ Other _____

**SPECIAL INSTRUCTIONS: _____

** ✓ ADD: DATE 5-23-94, ACTION CODE 482, 1994

** [] ADD: DATE _____, ACTION CODE 482, 1995

**COMMENTS _____

When recorded, mail to:

Name: LOCATOR

Address: _____

City/State/Zip Code: _____



94- 02773

OFFICIAL RECORDS OF LA PAZ COUNTY, AZ
PATRICIA WALL, LA PAZ COUNTY RECORDER
REC REQ BY: DON KILGORE
05 MAY 1994 02:08 PM PAGE 1 OF 2
RECORDING FEE \$ 10.00

Space above this line for Recorder's use

NOTICE OF MINING CLAIM

1. TYPE OF NOTICE: ☒ Location ☐ Amendment ☐ Relocation
2. TYPE OF CLAIM: ☐ Placer ☒ Lode ☐ Millsite ☐ Tunnelsite
3. The name and address of the Locator is
Name: William Baker, Carl Russell
Address: HCO1 Box 56
City/State/Zip Code: Salome, Az 85348
4. The name of the claim is True Blue
5. The date of the location is 5/4/94
6. The claim is 1500' feet long and 600' feet wide. The distance from the location monument to each end of the claim is 1500' feet in a Easterly direction and 0' feet in a Westerly direction.
7. The general course of the claim is from the West to the East
8. The location of the claim is in Section 9, Township 5N, Range 14 W, G+SR Base and Meridian, Ellsworth Mining District, La Paz County, State of Az.
9. If amending or relocating, the previous claim name was _____ recorded in Docket(Book) _____ page(s) _____ Mining District, _____ County, State of _____.
10. The location of the claim with reference to a natural object or permanent monument is Beginning at the S.W. corner of Sec 9 T5S N R14W go East 1200' then North 600' to the S.W. Cor of this claim S.W.

Dated: 5/4/94

William R. Baker
Signature

HCO1 Box 56
Address

Salome, Az 85348
City/State/Zip

MAP OF MINING CLAIM LOCATION

- The name of the claim is True Blue 14-02773
- The S.W. corner of the claim is 600' feet in a South direction to a survey monument or permanent natural object described as S.W. Cor of Sec 9
T5N Rng 14W
- The type of location monument is 2"X2"X4' Wood Post
The type of corner end monuments are 2"X2"X4' Wood Post
- The bearing and distance between the corners of the claim are beginning at the S.W. Cor corner of the claim, 600' feet in a North direction to the N.W. corner, then 1500' feet in a East direction to the N.E. corner, then 600' feet in a South direction to the S.E. corner, then 1500' feet in a West direction to the point of beginning.

MAP

One inch = One thousand feet

North Arrow

ONE MILE

ONE MILE

640 ACRES

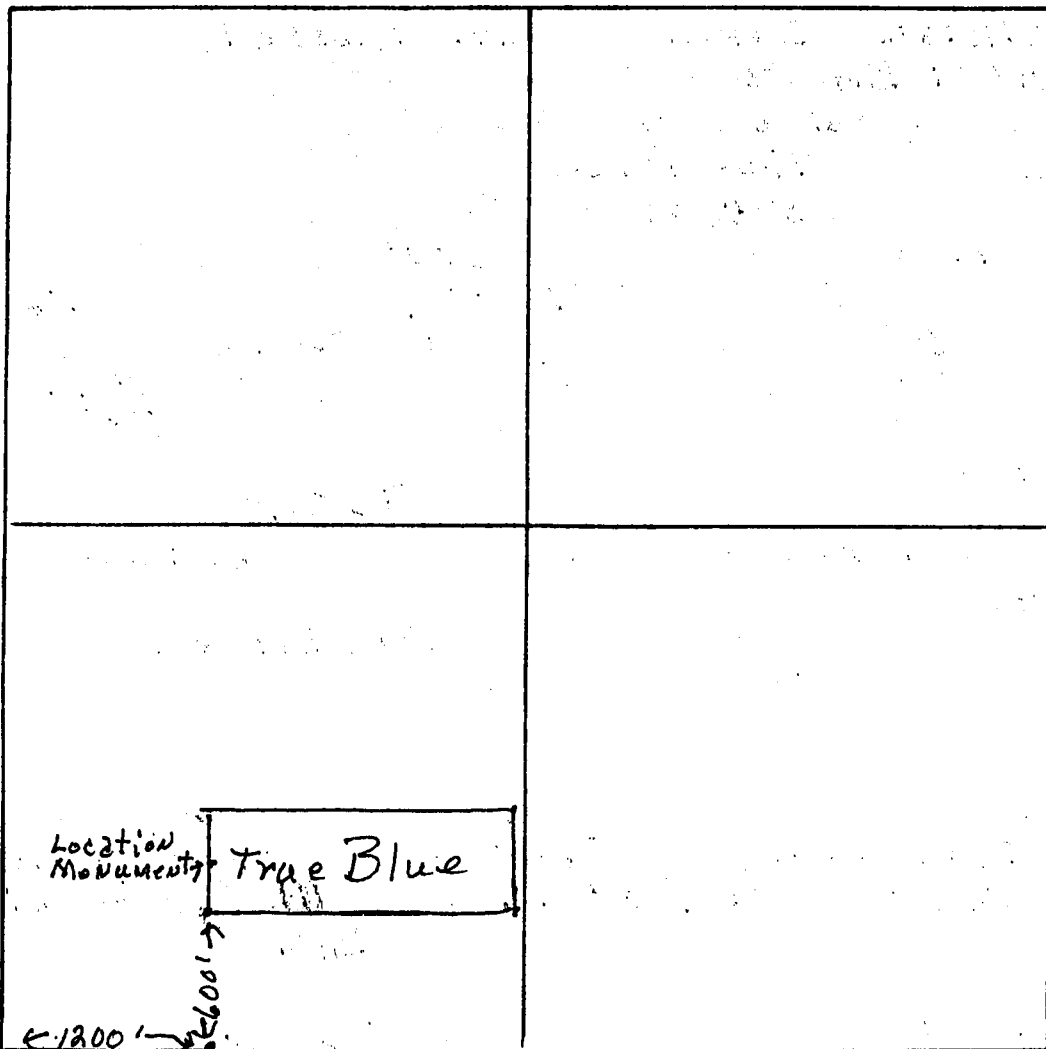

THIS SECTION WAS PREVIOUSLY LOCATED JAN 3, 1994 WITH BLM
AMC# 329660 TRK# AMC# 329679 - BUT AS OF MAY 4, 1994 NO NOTICE
OF LOCATION PAPERS HAVE BEEN PASTED ON THE GROUND

Section 9 Range 14 W Township 5N

G+S.R.

Base and Meridian.

Dated: 5/4/94

William B. Baker
Signature

When recorded, mail to:

Name: LOCATOR

Address: _____

City/State/Zip Code: _____

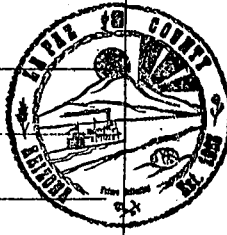

94- 02772

OFFICIAL RECORDS OF LA PAZ COUNTY, AZ
PATRICIA WALL, LA PAZ COUNTY RECORDER
REC REQ BY: DON KILGORE
05 MAY 1994 02:08 PM PAGE 1 OF 2
RECORDING FEE \$ 10.00

Space above this line for Recorder's use

NOTICE OF MINING CLAIM

1. TYPE OF NOTICE: ☒ Location ☐ Amendment ☐ Relocation
2. TYPE OF CLAIM: ☐ Placer ☒ Lode ☐ Millsite ☐ Tunnelsite
3. The name and address of the Locator is
Name: William H. Baker Carl Russell
Address: HCO1 Box 56
City/State/Zip Code: Salome, Az 85348
4. The name of the claim is True Blue #3
5. The date of the location is 5/4/94
6. The claim is 1500' feet long and 600' feet wide. The distance from the location monument to each end of the claim is 1500' feet in a Easterly direction and 0' feet in a Westerly direction.
7. The general course of the claim is from the West to the East
8. The location of the claim is in Section 9, Township 5N, Range 14W
- G+SR Base and Meridian,
Ellsworth Mining District, La Paz County,
State of Az
9. If amending or relocating, the previous claim name was _____
_____ recorded in Docket(Book) _____ page(s) _____
_____ Mining District, _____ County,
State of _____
10. The location of the claim with reference to a natural object or permanent monument is Beginning at the S.W. Cor of Sec 9 T5SN Rng14W go East 1200'
Then North 1200' to the S.W. Cor of this Claim

Dated: 5/4/94

William B. Baker
Signature
HCO1 Box 56
Address
Salome, Az 85348
City/State/Zip

MAP OF MINING CLAIM LOCATION

- The name of the claim is True Blue # 3 74-02772
- The S.W. corner of the claim is 1200' feet in a South direction to a survey monument or permanent natural object described as S.W. Cor Sec 9 T55N Rng 14 W
- The type of location monument is 2" X 2" X 4' Wooden Post
The type of corner end monuments are 2" X 2" X 4' Wooden Post
- The bearing and distance between the corners of the claim are beginning at the S.W. corner of the claim, 600' feet in a North direction to the N.W. corner, then 1500' feet in a East direction to the N.E. corner, then 600' feet in a South direction to the S.E. corner, then 1500' feet in a West direction to the point of beginning.

MAP

One inch = One thousand feet

North Arrow

ONE MILE

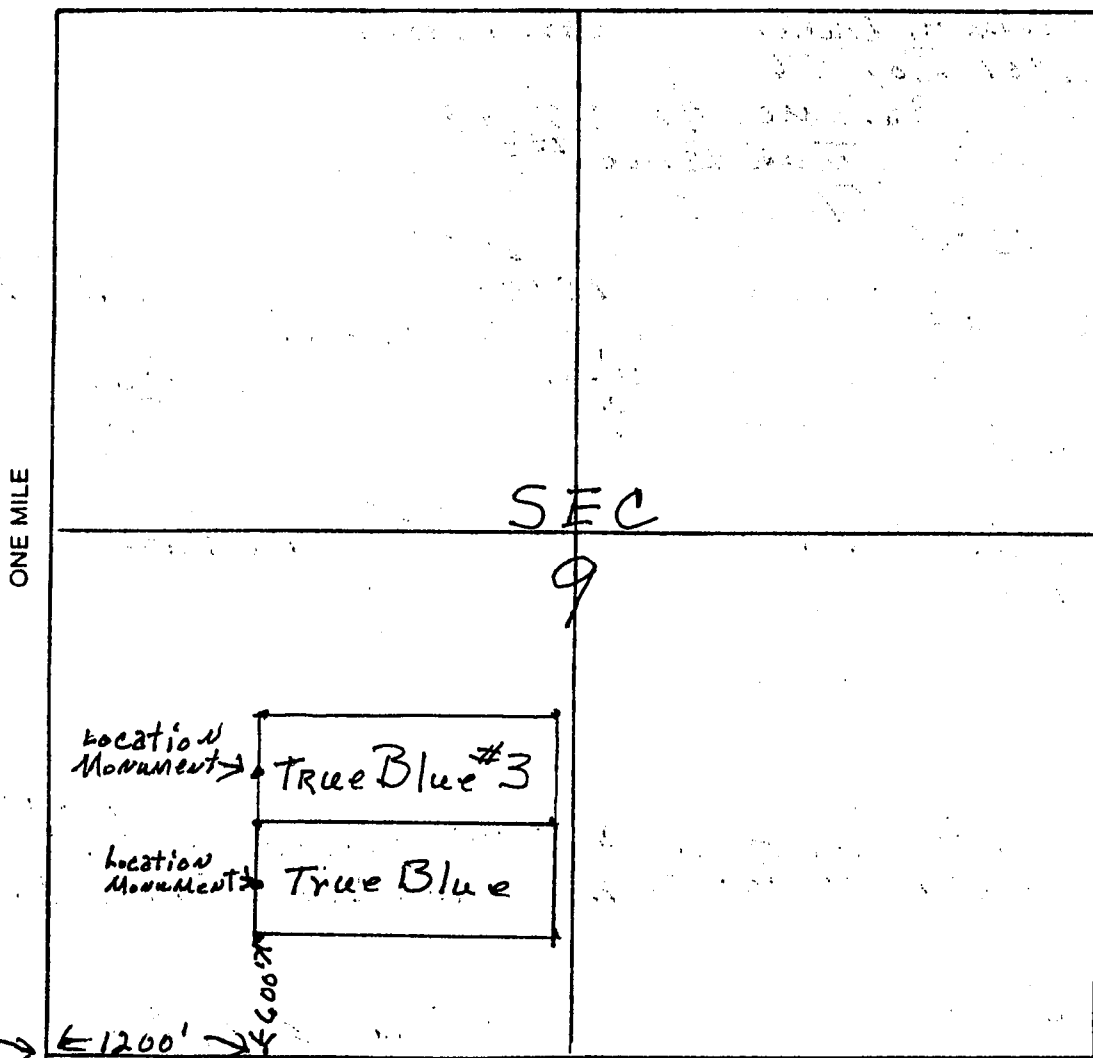

640 ACRES

THIS SECTION WAS PREVIOUSLY LOCATED JAN 3, 1994 WITH BLM AMC #329660
THRD AMC #329679 - BUT AS OF MAY 4, 1994 IN NOTICE OF LOCATION
PAPERS HAVE BEEN POSTED ON THE GROUND -

Section 9 Range 14 W Township 5 N
G + SR Base and Meridian.

Dated: 5/4/94 William B. Baker
Signature

23/94 ***

* 5/23
Bay
No Wilkins

GEOGRAPHIC STATE: ARIZONA MERIDIAN: 14 TOWNSHIP: 5-CN RANGE: 14-OW

SEC	SUBDIVISION	MIR	X-REFERENCE	NUMBER/TYPE/DISPOSITION/ACRES	PROPRIETOR/INTEREST/RELATIONSHIP
12	LOT 1			CASE: AZA 003956 TYPE: 240006 R&PP CLASS DISP: AUTHORIZED 03/25/70 ACRS: 00032.560	LA PAZ CNTY BD SUPV 100.00000% LESSEE
12	LOT 1			CASE: AZA 00395601 TYPE: 291200 R AND PP LEASE DISP: AUTHORIZED 04/06/70 ACRS: 00032.560	LA PAZ CNTY BD SUPV 100.00000% LESSEE
25	SWSW	14	3-DN 21-OW	CASE: AZA 008829	SOUTHWESTERN TEL CO 100.00000% HOLDER/BILLEE
30	NESW	14	3-DN 22-OW	TYPE: 286202 ROW-TELEPHONE-TELEG	
30	LOT 3,4	14	4-DN 14-OW	DISP: PENDING 07/31/92	
31	LOT 1,2	14	4-DN 16-OW	ACRS: 00045.140	
35	SENE, N2SE, SWSE, SESW	14	4-DN 17-OW		
36	W2NW	14	4-DN 18-OW		
		14	4-DN 19-OW		
		14	4-DN 20-OW		
		14	4-DN 21-OW		
		14	5-DN 15-OW		
28	SWSWNW NORTH OF DYKE			CASE: AZA 009421	AZ SHWY 100.00000% PERMITTEE
28	SWNWNW, NWSWNW			TYPE: 362113 FREE USE-ALL-GOVT	
29	SESENE, N2NWNSE			DISP: AUTHORIZED 05/15/87	
29	N2SENE, N2WSE			ACRS: 00065.260	
29	SENE, N2WSE				
29	BETWEEN DYKE & RAILROAD				
29	S2N2 (ROAD)				
29	E2NESENE, SWNESENE				
29	S2SWSENE, S2SESWNE				
29	N2NENWSE				
30	SESENE (ROAD)				
1	LOT 1,5,6,7	14	3-DN 4-OW	CASE: AZA 013875	BR AZ PROJECT OFF 100.00000% HOLDER
12	LOT 1,2,3,4	14	3-DN 5-OW	TYPE: 285003 ROW-POWER TRANS,FLP	
13	LOT 1,2,3,4	14	3-DN 13-OW	DISP: AUTHORIZED 02/20/81	
24	LOT 1,2,3,4	14	3-DN 14-OW	ACRS: 00524.080	
25	SWNE, SESW, W2SE	14	4-DN 4-OW		
25	LOT 1,2	14	4-DN 14-OW		
36	E2NW, N2SW, SWSW	14	6-DN 13-OW		
		14	6-DN 14-OW		
		14	7-DN 12-OW		
		14	7-DN 13-OW		
		14	7-DN 14-OW		
		14	7-DN 15-OW		
		14	7-DN 16-OW		

GEOGRAPHIC STATE: ARIZONA MERIDIAN: 14 TOWNSHIP: 5-ON RANGE: 14-OW

SEC	SUBDIVISION	NIR	X-REFERENCE	NUMBER/TYPER/TYPE/POSITION/ACRES	PROPRIETOR/INTEREST/RELATIONSHIP
30	W2W2 OF LOTS 3 & 4	14	5-ON 15-OW	CASE: AZA 016012	AZ PUBLIC SERVICE CO 100.00000% HOLDER
31	W2W2 OF LOTS 1-4			TYPE: 285003 ROW-POWER TRANS, FLP DISP: AUTHORIZED 03/26/82 ACRS: 00002.800	
24	LOT 4	14	4-ON 14-OW	CASE: AZA 016483	SOUTHWESTERN TEL CO 100.00000% HOLDER/BILLEE
25	NWNE, W2	14	4-ON 16-OW	TYPE: 286203 ROW-TEL & TELEG, FL	
35	SENE, SESW, SE	14	4-ON 17-OW	DISP: AUTHORIZED 05/20/81	
36	NW	14	4-ON 18-OW	ACRS: 00050.330	
		14	4-ON 19-OW		
		14	5-ON 13-OW		
20	NWSW, NENENW, S2NENW			CASE: AZA 018980	LA PAZ CO PUB WORKS 100.00000% PERMITTEE
20	NESWNW, S2SWNW, NESENW			TYPE: 362113 FREE USE-ALL-GOVT	
20	W2SENW			DISP: AUTHORIZED 12/13/83 ACRS: 00130.000	
35	SE	14	1-ON 7-0E	CASE: AZA 019369	AMERICAN TEL & TEL 100.00000% HOLDER/BILLEE
36	NW	14	1-ON 8-0E	TYPE: 286203 ROW-TEL & TELEG, FL	
		14	2-ON 6-0E	DISP: AUTHORIZED 09/25/85	
		14	2-ON 7-0E	ACRS: 00028.666	
		14	8-OS 12-0E		
30	LOT 4	14	1-ON 7-0E	CASE: AZA 022075	BR AZ PROJECT OFF 100.00000% HOLDER
31	E2W2	14	1-ON 9-OW	TYPE: 287007 ROW-WATER FACILITY	
31	LOT 1,2,3	14	1-ON 10-OW	DISP: PENDING 06/10/92	
		14	1-OS 10-OW	ACRS: 00001.000	
		14	2-ON 6-0E		
		14	2-ON 6-OW		
		14	2-ON 7-0E		
		14	2-ON 7-OW		
		14	2-ON 8-OW		
		14	2-ON 9-OW		
		14	2-ON 10-OW		
		14	2-OS 8-0E		
		14	3-ON 5-OW		
		14	3-ON 6-OW		
		14	3-ON 7-OW		
		14	3-ON 8-OW		
		14	3-ON 9-OW		
		14	3-ON 10-OW		
		14	3-ON 12-OW		
		14	3-ON 13-OW		
		14	3-ON 14-OW		
		14	4-ON 3-OW		
		14	4-ON 4-0E		
		14	4-ON 4-OW		
		14	4-ON 14-OW		
		14	4-OS 9-0E		

GEOGRAPHIC STATE: ARIZONA MERIDIAN: 14 TOWNSHIP: 5-ON RANGE: 14-OW

SEC	SUBDIVISION	MIR	X-REFERENCE	NUMBER/TYPE/DISPOSITION/ACRES	PROPRIETOR/INTEREST/RELATIONSHIP
		14	4-OS	10-OE	
		14	5-ON	1-DE	
		14	5-ON	1-OW	
		14	5-ON	15-OW	
		14	5-OS	10-OE	
		14	6-ON	15-OW	
		14	7-ON	15-OW	
		14	7-ON	16-OW	
		14	7-OS	4-OE	
		14	8-ON	16-OW	
		14	8-ON	17-OW	
		14	9-ON	17-OW	
		14	10-ON	17-OW	
		14	10-OS	11-DE	
		14	12-OS	11-OE	
		14	13-OS	11-DE	
		14	14-OS	12-OE	
		14	15-OS	12-DE	
32	ALL	14	1-ON	14-OW	CASE: AZA 022098PT TYPE: 221006 EX-STATE SEC 206, F DISP: AUTHORIZED 05/12/87 ACRS: 33995.040 BLM PHOENIX DO 100.00000% ADMIN NGT ENT
36	W2E2, W2	14	1-OS	7-OW	
36	LOT 1-4	14	1-OS	8-OW	
		14	1-OS	9-OW	
		14	1-OS	10-OW	
		14	2-ON	10-OW	
		14	2-ON	14-OW	
		14	3-ON	7-OW	
		14	3-ON	9-OW	
		14	3-ON	12-OW	
		14	4-ON	7-OW	
		14	4-ON	8-OW	
		14	4-ON	11-OW	
		14	4-ON	12-OW	
		14	4-ON	14-OW	
		14	5-ON	12-OW	
		14	5-ON	13-OW	
		14	6-ON	9-OW	
		14	6-ON	13-OW	
		14	6-ON	15-OW	
		14	6-ON	16-OW	
		14	7-ON	11-OW	
		14	7-ON	14-OW	
		14	7-ON	17-OW	
		14	9-ON	10-OW	
		14	10-ON	10-OW	
		14	11-ON	13-OW	
		14	11-ON	14-OW	
		14	12-ON	14-OW	
		14	13-ON	18-OW	
		14	28-ON	16-OW	

GEOGRAPHIC STATE: ARIZONA MERIDIAN: 14 TOWNSHIP: 5-ON RANGE: 14-OW

SEC	SUBDIVISION	NTR X-REFERENCE	NUMBER/TYPE/DISPOSITION/ACRES	PROPRIETOR/INTEREST/RELATIONSHIP
		14 28-ON 17-OW		
14	PORTION OF		CASE: AZA 024134	RIGGS ENTERPRISE 100.00000% OPERATOR
15	PORTION OF		TYPE: 380913 SURFACE MGT-NOTICE	
22	PORTION OF		DISP: PENDING 09/12/89	
			ACRS: 00001.000	
15	PORTION OF		CASE: AZA 024146	RIGGS ENTERPRISE 100.00000% OPERATOR
			TYPE: 380913 SURFACE MGT-NOTICE	
			DISP: PENDING 07/17/89	
			ACRS: 00001.000	
9	PORTION OF		CASE: AZA 024585	BAKER WILLIAM 100.00000% OPERATOR
			TYPE: 380913 SURFACE MGT-NOTICE	
			DISP: PENDING 03/28/88	
			ACRS: 00001.000	
17	ALL	14 5-ON 15-OW	CASE: AZA 024646	LITTLE BEAR RES 90.00000% OPERATOR
18	ALL		TYPE: 380913 SURFACE MGT-NOTICE	RADVAK STEVE 5.00000% OPERATOR
			DISP: PENDING 04/16/86	WAGNER ROBERT D 5.00000% OPERATOR
			ACRS: 00001.000	
9	PART		CASE: AZA 025068	LATHROP KENNETH 0.00000% OPERATOR
16	PART		TYPE: 380913 SURFACE MGT-NOTICE	LATHROP KENNETH 100.00000% CLAIMANT
			DISP: PENDING 01/30/91	
			ACRS: 00001.000	
9	SW		CASE: AZA 025951	BAKER WILLIAM 50.00000% CLAIMANT
			TYPE: 380913 SURFACE MGT-NOTICE	RUSSELL CARL 50.00000% CLAIMANT
			DISP: AUTHORIZED 10/25/91	
			ACRS: 00005.000	
21	SWNW		CASE: AZA 025952	BAKER WILLIAM 50.00000% CLAIMANT
			TYPE: 380913 SURFACE MGT-NOTICE	RUSSELL CARL 50.00000% CLAIMANT
			DISP: AUTHORIZED 10/25/91	
			ACRS: 00005.000	
25	SW		CASE: AZA 026914	CJ INT VENTURES INC 0.00000% OPERATOR
26	NWNESE		TYPE: 380913 SURFACE MGT-NOTICE	CJ INT VENTURES INC 100.00000% CLAIMANT
			DISP: AUTHORIZED 05/30/85	
			ACRS: 00001.000	
8	PART		CASE: AZA 026935	VANDERWALL WILLIAM C 0.00000% OPERATOR
9	PART		TYPE: 380913 SURFACE MGT-NOTICE	VANDERWALL WILLIAM C 100.00000% CLAIMANT
			DISP: CLOSED 04/10/90	
			ACRS: 00001.000	

GEOGRAPHIC STATE: ARIZONA MERIDIAN: 14 TOWNSHIP: 5-0N RANGE: 14-0W

SEC	SUBDIVISION	MTL X-REFERENCE	NUMBER/TYPER/DISPOSITION/ACRES	PROPRIETOR/INTEREST/RELATIONSHIP
7	PART	14 6-0N 14-0W	CASE: AZA 026939 TYPE: 380913 SURFACE MGT-NOTICE DISP: CLOSED 04/10/90 ACRS: 00001.000	WILLMORE CHARLES E 0.00000% OPERATOR WILLMORE CHARLES E 100.00000% CLAIMANT
7	PART		CASE: AZA 026940 TYPE: 380913 SURFACE MGT-NOTICE DISP: CLOSED 11/09/90 ACRS: 00001.000	WILLMORE CHARLES E 0.00000% OPERATOR WILLMORE CHARLES E 100.00000% CLAIMANT
5	PART		CASE: AZA 026948 TYPE: 380913 SURFACE MGT-NOTICE DISP: AUTHORIZED 11/30/82 ACRS: 00001.000	WILLMORE CHARLES E 0.00000% OPERATOR WILLMORE CHARLES E 100.00000% CLAIMANT
6	PART			
26	N2SE		CASE: AZA 026976 TYPE: 380913 SURFACE MGT-NOTICE DISP: CLOSED 07/16/90 ACRS: 00001.000	CJ INT VENTURES INC 0.00000% OPERATOR WAX WILBERT M 100.00000% CLAIMANT
7	PART		CASE: AZA 026978 TYPE: 380913 SURFACE MGT-NOTICE DISP: CLOSED 06/08/89 ACRS: 00001.000	WILLMORE CHARLES E 0.00000% OPERATOR WILLMORE CHARLES E 100.00000% CLAIMANT
8	PART			
16	SE		CASE: AZA 026979 TYPE: 380913 SURFACE MGT-NOTICE DISP: AUTHORIZED 02/07/84 ACRS: 00001.000	WILLMORE CHARLES E 0.00000% OPERATOR WILLMORE CHARLES E 100.00000% CLAIMANT
17	PART	14 3-0N 20-0W	CASE: AZA 026982 TYPE: 380913 SURFACE MGT-NOTICE DISP: CLOSED 04/10/90 ACRS: 00001.000	CHEESEMAN EXPL CO 0.00000% OPERATOR CHEESEMAN EXPL CO 100.00000% CLAIMANT
20	PART	14 4-0N 16-0W 14 5-0N 6-0W 14 5-0N 10-0W 14 5-0N 12-0W 14 13-0N 3-0W 14 14-0N 3-0W		
7	PART	14 5-0N 15-0W	CASE: AZA 026987 TYPE: 380913 SURFACE MGT-NOTICE DISP: CLOSED 06/06/89 ACRS: 00001.000	WEACO EXPLORATION 0.00000% OPERATOR WEACO EXPLORATION 100.00000% CLAIMANT
18	PART			
20	NWSW		CASE: AZA 028078 TYPE: 362113 FREE USE-ALL-GOVT DISP: AUTHORIZED 12/02/93 ACRS: 00130.000	LA PAZ CO PUB WORKS 100.00000% PERMITTEE
20	E2NENW, SWNENW, E2SWNW			
20	SWSWNW, N2SENW, SWSENW			

GEOGRAPHIC STATE: ARIZONA MERIDIAN: 14 TOWNSHIP: 5-ON RANGE: 14-OW

SEC	SUBDIVISION	MIR_X-REFERENCE	NUMBER/TYPE/DISPOSITION/ACRES	PROPRIETOR/INTEREST/RELATIONSHIP
7	E2		CASE: AZA 028211	BIRCH MARION 100.00000% OPERATOR
8	NW		TYPE: 380913 SURFACE MGT-NOTICE	
			DISP: AUTHORIZED 11/08/93	
			ACRS: 00002.000	
30	E2NW, SWNE	14 1-ON 3-OW	CASE: AZAR 0003774	AZ INTERST STREAM 100.00000% HOLDER
32	NENW, W2NE, SENE, NESE	14 2-ON 3-OW	TYPE: 287100 ROW-IRRIGATION FAC	
33	W2SW, SESW	14 2-ON 7-OW	DISP: CLOSED 07/15/85	
		14 2-ON 8-OW	ACRS: 00139.700	
		14 3-ON 4-OW		
		14 3-ON 5-OW		
		14 3-ON 6-OW		
		14 3-ON 7-OW		
		14 3-ON 8-OW		
		14 3-ON 9-OW		
		14 3-ON 10-OW		
		14 3-ON 11-OW		
		14 3-ON 12-OW		
		14 3-ON 13-OW		
		14 3-ON 14-OW		
		14 4-ON 14-OW		
		14 5-ON 15-OW		
		14 6-ON 15-OW		
		14 7-ON 15-OW		
		14 7-ON 16-OW		
		14 8-ON 16-OW		
		14 9-ON 16-OW		
		14 9-ON 17-OW		
		14 10-ON 17-OW		
		14 11-ON 17-OW		
		14 11-ON 18-OW		
25	S2SWSW		CASE: AZAR 0008104	AZ PUBLIC SERVICE CO 100.00000% HOLDER
36	N2NWNW		TYPE: 282102 MATERIAL SITES (SEC	
			DISP: CLOSED 01/30/92	
			ACRS: 00008.000	
24	SWSE		CASE: AZAR 0008902	AZ SHWY 100.00000% PERMITTEE
24	LOT 4		TYPE: 282105 FED AID HIGHWAY (SE	
			DISP: AUTHORIZED 07/19/55	
			ACRS: 00008.720	
35	SESW, S2SE, NESE, SENE		CASE: AZAR 0008904	AZ SHWY 100.00000% PERMITTEE
			TYPE: 282105 FED AID HIGHWAY (SE	
			DISP: AUTHORIZED 07/19/55	
			ACRS: 00018.370	

GEOGRAPHIC STATE: ARIZONA MERIDIAN: 14 TOWNSHIP: 5-ON RANGE: 14-OW

SEC	SUBDIVISION	MIR	X-REFERENCE	NUMBER	TYPE	DISPOSITION	ACRES	PROPRIETOR/INTEREST/RELATIONSHIP
36	W2NW			CASE: AZAR 0008905				AZ SHWY 100.00000X PERMITTEE
				TYPE: 282105 FED AID HIGHWAY (SE				
				DISP: AUTHORIZED 07/19/55				
				ACRS: 00005.970				
25	NWNE, E2NW, E2SW, SWSW			CASE: AZAR 0008907				AZ SHWY 100.00000X PERMITTEE
				TYPE: 282105 FED AID HIGHWAY (SE				
				DISP: AUTHORIZED 07/19/55				
				ACRS: 00013.770				
24	LOT 4	14	5-ON 13-OW	CASE: AZAR 0015120				AZ PUBLIC SERVICE CO 100.00000X HOLDER
				TYPE: 285002 ROW-POWER TRANS LIN				
				DISP: AUTHORIZED 07/09/57				
				ACRS: 00005.270				
32	W2W2	14	4-ON 14-OW	CASE: AZAR 0015264				AZ PUBLIC SERVICE CO 100.00000X HOLDER/BILLEE
				TYPE: 285002 ROW-POWER TRANS LIN				
				DISP: AUTHORIZED 11/22/57				
				ACRS: 00002.467				
30	E2SW			CASE: AZPHX 0000251				AZ & CA RR CO 100.00000X HOLDER
30	LOT 1,2			TYPE: 284200 RR & STATIONS OUTSI				
				DISP: AUTHORIZED 01/13/09				
				ACRS: 00005.510				
24	SE, SESESW	14	5-ON 15-OW	CASE: AZPHX 0078172				AT & SF RR CO 100.00000X PERMITTEE
25	W2	14	6-ON 10-OW	TYPE: 281099 TO BE DEFINED				
26	SESE	14	6-ON 11-OW	DISP: AUTHORIZED 12/03/37				
27	SE, NESW, S2S2NW	14	6-ON 13-OW	ACRS: 01611.310				
28	S2S2NE, NWNWSE, N2N2SW	14	6-ON 15-OW					
29	N2S2	14	6-ON 16-OW					
30	N2SE, NENESW, S2NW	14	7-ON 7-OW					
34	NENE	14	7-ON 8-OW					
35	W2SE, NWNWNE, E2SW, NW	14	7-ON 9-OW					
		14	7-ON 10-OW					
		14	8-ON 5-OW					
		14	8-ON 6-OW					
		14	8-ON 7-OW					
29	SWSE	14	5-ON 15-OW	CASE: AZPHX 0079054				AZ SHWY 100.00000X HOLDER
30	SW, SENW	14	6-ON 16-OW	TYPE: 282105 FED AID HIGHWAY (SE				
33	S2, S2NE, NW	14	7-ON 16-OW	DISP: AUTHORIZED 07/20/83				
34	S2	14	7-ON 17-OW	ACRS: 00475.210				
25	W2NE, SENW, E2SW	14	3-ON 11-OW	CASE: AZPHX 0083392				AMERICAN TEL & TEL 100.00000X HOLDER/BILLEE
25	LOT 1	14	3-ON 21-OW	TYPE: 286203 ROW-TEL & TELEO, FL				
35	SE	14	3-ON 22-OW	DISP: AUTHORIZED 03/12/85				
36	NWSW, NW	14	4-ON 12-OW	ACRS: 00193.570				
		14	4-ON 14-OW					

GEOGRAPHIC STATE: ARIZONA MERIDIAN: 14 TOWNSHIP: 5-0N RANGE: 14-0W

SEC	SUBDIVISION	MTL	X-REFERENCE	NUMBER/TYFE/DISPOSITION/ACRES	PROPRIETOR/INTEREST/RELATIONSHIP
		14	4-0N	16-0W	
		14	4-0N	17-0W	
		14	4-0N	18-0W	
		14	4-0N	19-0W	
		14	4-0N	20-0W	
		14	4-0N	21-0W	
		14	5-0N	12-0W	
		14	5-0N	13-0W	
24	S2	14	5-0N	13-0W	CASE: AZPHX 0086650
25	W2	14	5-0N	15-0W	TYPE: 281099 TO BE DEFINED
26	PROT SE	14	6-0N	10-0W	DISP: AUTHORIZED 05/08/05
27	PROT SE, NESW, S2NW	14	6-0N	11-0W	ACRS: 01908.670
28	S2N2, N2SW	14	6-0N	12-0W	
29	N2S2, S2N2	14	6-0N	13-0W	
30	N2SE, N2SW, S2NW	14	7-0N	7-0W	
34	NENE	14	7-0N	8-0W	
35	W2NE, NWSE, NESW, W2NW	14	7-0N	9-0W	
		14	7-0N	10-0W	
		14	8-0N	5-0W	
		14	8-0N	6-0W	
		14	8-0N	7-0W	